

USE AND MAINTENANCE MANUAL

INDUSTRIAL VACUUM

SERIES

CLEAN OIL



This manual forms an integral part of the vacuum cleaner.

Read this manual and the other attachments supplied carefully. Knowledge of the instructions here contained is indispensable for the safe use and maintenance of the vacuum cleaner.

Rev. 0 dated 10/2017

Summary

1.	INFORMATIVE SECTION	4
1.1	Foreword	4
1.2	Identification of the main parts	6
1.3	Optional parts	7
1.4	Manufacturer's identification data	7
1.5	Identification plate	7
1.6	Permitted Uses	7
1.7	Authorised environmental conditions	7
1.8	Noise level	8
1.9	Technical data	8
1.10	Guarantee	9
2	SAFETY SECTION	10
2.1	Safety information	10
2.2	Safety measures	11
2.3	Safety plates and symbols	12
2.4	Residual risks	14
2.5	Applied Directives	14
3	HANDLING, UNPACKING AND INSTALLATION SECTION	15
3.1	Handling	15
3.2	Unpacking	16
3.3	Installation	18
4.	OPERATION SECTION	20
4.1	Description of controls	20
4.2	Work cycle	20
4.3	Emptying the container with FLOW INVERSION VALVE	22
4.4	Emptying the waste container	24
4.5	Inserting and locking the waste container	26
4.6	Storage - decommissioning	26
5.	MAINTENANCE SECTION	27
5.1	Informative notes	27
5.2	General safety regulations	28
5.3	Replacing the oil mist filter	30
5.4	Troubleshooting	32
5.5	Scrapping	33



IMPORTANT - The DEPURECO name and logo used in this document refer to and are property of **DEPURECO INDUSTRIAL VACUUMS S.r.l.**

This document remains the exclusive property of DEPURECO S.r.l. Full or partial reproduction by any means (graphical, electronic, etc.) is prohibited without prior authorisation from the Company Management.

1. INFORMATIVE SECTION

1.1 Foreword

Dear Customer

Thank you and congratulations for choosing DEPURECO and a DEPURECO CLEAN OIL series vacuum cleaner.

This manual has been prepared for you to fully appreciate the quality of this machine.

Please read all sections before using the machine for the first time.

It includes information, recommendations and important warnings concerning the use of the vacuum, which will help fully exploit the technical properties of your machine.

Read messages, warnings and indications preceded by the following symbols carefully:



for personal safety;



for vacuum integrity;



for protecting the environment.

This vacuum has been designed for the suction of liquids and/or liquids with suspended solids.

Liquids ingested tend to deposit in the container below (in the event of liquids with solids, which are deposited in the basket inside the container). Suspended liquids are conveyed by the air flow until deposited on the surface of the oil mist filter positioned on the upper part of the filter chamber.

This manual describes the following models:

CLEAN OIL

The vacuum cleaners are fitted with oil mist filter:

- ☐ **P11753/A polyurethane sheet 45 PPI**
(to be paired with P11830/A and P11830/B)



This manual provides all the necessary information for the use and maintenance of your vacuum.

This specific model has undergone strict testing to ensure maximum reliability. Its operation and durability will depend on proper use and maintenance.

This manual forms an integral part of the vacuum cleaner and must accompany the machine for its entire life cycle.

In the event it is lost or damaged, you can request another copy from DEPURECO INDUSTRIAL VACUUMS S.r.l. (henceforth shortened to DEPURECO).

The technical information contained in this manual is exclusive property of DEPURECO and must be considered confidential.

Reproduction, even partial, of graphics, text and illustrations is prohibited by law.

Some details shown in the figures in this manual may differ from those on your vacuum; this is because some components can be removed to ensure maximum illustration clarity.

This manual has been divided into sections for easy consultation and each section has been identified by a specific graphical symbol.

The topics covered in this manual are those expressly required by Machinery Directive 2006/42/EC and the technical data are taken from the technical file archived at DEPURECO.

With reference to Regulation 1907/2006/EC (REACH), DEPURECO hereby declares that no Substances of Very High Concern (SVHC) included in the Candidate List, are contained in its products.

This manual must be stored in a place that is accessible to all personnel required to operate or carry out maintenance on the vacuum cleaner.

In the event of any dispute arising, the Court of Torino (Italy) shall have jurisdiction.



The manual must accompany the vacuum cleaner in the event of it being resold!



1.2 Identification of the main parts

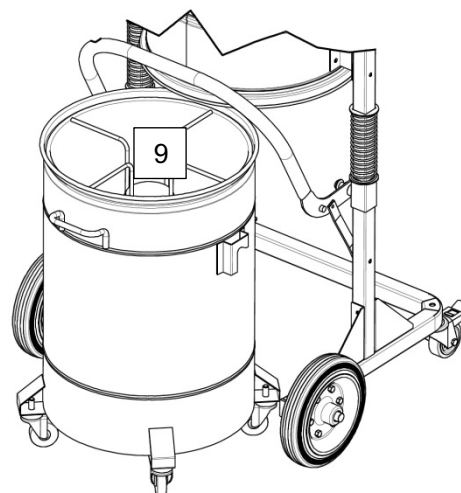
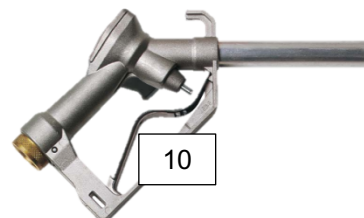
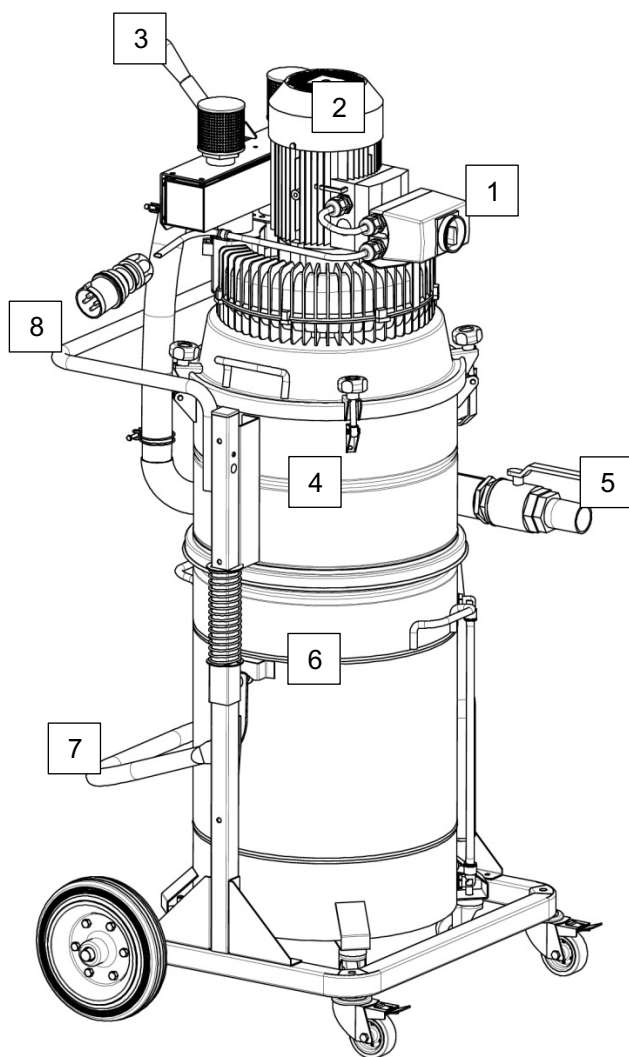

1. I/O Switch: on and off
2. vacuum pump
3. Flow inverter valve
4. Filter chamber
5. Suction nozzle with valve
6. container
7. container detachment lever
8. Handle for moving
9. Removable basket with floater
10. Liquid expulsion pistol



1.3 Optional parts

A wide range of optional accessories is available from DEPURECO depending on the intended use of the vacuum.

1.4 Manufacturer's identification data

DEPURECO INDUSTRIAL VACUUMS S.r.l.

Corso Europa 609 - 10088 Volpiano (TO) - ITALY

tel. +39 011 98 59 117

fax +39 011 98 59 326

e-mail: depureco@depureco.com

website: www.depureco.com

VAT No. 02258610357

1.5 Identification plate

The data on the vacuum identification plate must be referred to in any correspondence with the manufacturer or the dealer.

DEPURECO S.r.l.				Corso Europa 609 - 10088 Volpiano (TO) - ITALIA tel. +39 011 98 59 117 - fax +39 011 98 59 326 MADE IN ITALY	
Mod.			Volt		
Serial N°	kW	Amp	Hz		
Dust class	IP	Kg	Year		

1.6 Permitted Uses

This specific vacuum cleaner model has been designed, built and protected exclusively for professional industrial use for the suction of liquids and/or liquids with solid suspensions, provided they are not inflammable nor toxic.

Any other use is considered **IMPROPER**.

1.7 Authorised environmental conditions

To ensure correct operation, the vacuum cleaner must be kept away from atmospheric agents (rain, hail, snow, fog, dust in suspension, etc.) in an area with a room temperature range between 5° and 45°C and a relative humidity no higher than 70%.

The work environment must be clean, suitably lit and must not give rise to potentially explosive atmosphere.



1.8 Noise level

Photometric tests carried out on these specific models have shown a sound pressure level of

CLEAN OIL

78 dB(A)



Warning!

Workers exposed to sound pressure levels higher than 85 dB(A) must be protected by a suitable individual protection device as e.g. acoustic individual protection device type-approved.



Under these conditions, workers must be provided with adequate training and information on risks arising from noise exposure.

1.9 Technical data

FEATURES	MEASUREMENT UNIT	CLEAN OIL
Weight	Kg	95
Overall dimensions LxD	cm	70×118
Overall dimensions H	cm	132
Supply voltage	V-Hz	240-50/60
Power	kW	2,4
Maximum negative pressure	mBar	250
Air flow rate	mc/h	380
Suction time	L/sec	100/30
Discharge time	L/sec	100/50
Noise level	dB(A)	70
Container capacity	L	130
Solids container	L	40
Suction nozzle diameter	mm	50



1.10 Guarantee

DEPURECO guarantees this vacuum cleaner model for a period of 12 months from the date of purchase as indicated on the invoice emitted at the moment of product delivery by the retailer.

The guarantee is null and void in the event that the vacuum is repaired by unauthorised third parties or by using equipment, accessories or components not supplied or not authorised by DEPURECO, or if the serial number is removed (during the guarantee period).

For the duration of the guarantee, DEPURECO undertakes to repair or replace free of charge parts and components which prove to have manufacturing defects.

Repairs will be exclusively executed at a DEPURECO site or in a DEPURECO approved Assistance Centre and the machine must be sent free of charge (freight cost at user's charge unless otherwise agreed).

The guarantee does not cover cleaning of working parts.

The purchase invoice must be shown to the authorised technical personnel carrying out the repair and must accompany the vacuum during its shipment.

Defects that are not evidently due to materials or manufacturing will be examined solely at our premises or at a Technical Service Centre of our choosing.

Should the complaint be unjustified, all repair and/or replacement expenses shall be charged to the purchaser.

In any case, the following items are not covered by the guarantee: accidental damage due to transport, negligence, abnormal use, improper use, non-compliance with the instructions contained in this booklet or arising from phenomena that do not depend on normal use/operation of the vacuum.

DEPURECO shall not be held liable for any injuries to persons or damage to objects caused by misuse or improper use of the vacuum.

In the event of any dispute arising, the Court of Torino (Italy) shall have jurisdiction.



To claim under terms of this guarantee, a photocopy of the form on last page of this manual should be made, filled in completely (preferably in block capitals), and sent by fax to DEPURECO at the number +39 011 9859 326



2 SAFETY SECTION

2.1 Safety information



As per Italian Legislative Decree 81/08 and subsequent modifications, the Safety Manager must train and inform workers about risks involved with using the vacuum cleaner so that they may be able to avoid injury to themselves and others.

Failure to comply norms, laws or basic safety precautions, may cause accidents during operation, maintenance and repair of the vacuum cleaner. Accidents can frequently be avoided by recognising potentially hazardous situations before they occur. Adequate training is crucial to this end.

DEPURECO shall not be held liable for accidents or damage due to the improper use of the vacuum by untrained personnel or to failure to comply, even partially, with the occupational safety standards and intervention procedures contained in this manual.

Safety warnings and precautions are indicated in this manual as well as on the product itself.

Operators must pay special attention to these hazard warnings to prevent accidents with serious consequences for themselves and other people.

Safety messages are indicated by the following symbols:



Warning!

Failure to comply with these messages can cause injuries to the operator.



Warning!

Failure to comply with these messages can cause damage to the vacuum.



Warning!

Failure to comply with these messages can harm the environment.

DEPURECO designs and manufactures its equipment and accessories with care, identifying and compensating possible risks related to their use. In the event of equipment, procedures, work methods or techniques not expressly provided for by DEPURECO being used, it is crucial to ensure beforehand that there are no dangers for oneself and the others. Nevertheless, DEPURECO shall not be held liable.

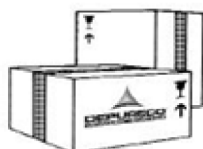

Only use original DEPURECO replacement parts

Depureco will not be held liable for the use of non-original parts.



2.2 Safety measures



Warning!

The following information is important for the prevention of all hazards which may occur during vacuum operation. However, they cannot replace the expertise and common sense of operators as an overall framework for the prevention of accidents.

Each section lists further safety measures specific to the various functions.

CAUTION!

- This vacuum may only be used by suitably trained adults.
- This vacuum cleaner is intended for industrial use, e.g.: in factories, warehouses, workshops.
- Ensure that mains electrical connects have suitable earthing.
- This vacuum cleaner should not be used in corrosive or potentially explosive atmospheres.
- Keep the vacuum cleaner clear of foreign objects such as debris, oil, tools and other objects which may impede its functioning and cause personal injury.
- Avoid the use of toxic or inflammable solvents, such as petrol, benzene, ether and alcohol for cleaning.
- Avoid prolonged contact with solvents and inhaling their vapours.
- Avoid using near open flames or heat sources; ensure adequate ventilation.
- Never use the vacuum cleaner without a filter.
- Do not vacuum lit cigarettes: the filter may catch fire.
- Do not vacuum petroleum products or inflammable liquids in general.
- Ensure that all protection equipment and guards are in place and that all safety devices are present and operating.
- Do not wear loose or flowing apparel such as ties, scarves, or torn clothing that could become hung or caught up by the vacuum cleaner.
- Never open waste container while the vacuum cleaner is working.
- Never put hands inside the container positioning guides: the movement of the lifting handle could lead to fingers being crushed.
- Never use extension leads, plug-in connection devices and adapters.
- Do not climb on the vacuum cleaner.
- Do not touch electrical wires, switches, buttons, etc. with wet hands.
- Occasionally check the integrity of the power cable.
- When using the industrial vacuum cleaner, some components (motor connector, motor body in particular) may reach high temperatures.
- During operations to return to original work conditions, the personnel in charge must ensure at the end of the procedure that normal operating and safety conditions of the vacuum and, in particular, of the safety devices and protective guards involved in the operation are once again guaranteed.
- Should the Customer install a tool not supplied by DEPURECO on the vacuum, the safety requirements of Machinery Directive 2006/42/EC must be met. Nevertheless DEPURECO shall not be held liable for problems caused by the use of such parts.



- Structural damage, alterations or improper repairs can modify the protective capacity of the vacuum, thereby nullifying this certification and releasing DEPURECO from any liability.
- This manual must be kept near the machine, so it may be consulted to check the correct cycle use at any time doubts may arise.
- In the event it is lost or damaged, request another copy from DEPURECO.



Warning!

This vacuum cleaner may contain liquids that may be hazardous to your health.

Emptying and maintenance procedures, including the disposal of the container must only be carried out by specialised personnel wearing suitable personal protective equipment.

Never switch the machine on without an complete filtering system in place.

2.3 Safety plates and symbols

Plates with safety symbols and/or messages are applied to the vacuum and its packaging.

These pages show their precise location and the nature of the hazard.



Warning!

Ensure that all safety messages are perfectly legible.

Clean them using a cloth with water and soap. Do not use solvents, naphtha or petrol.

Request replacements for damaged plates from DEPURECO.

In the event that a plate is located on a piece that is replaced, ensure that a new plate is affixed to the new piece.

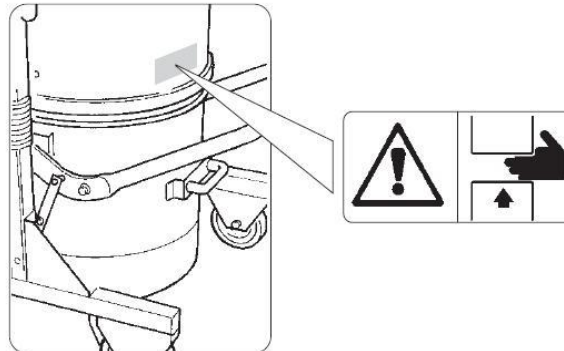

Warning!

Upper limb crushing hazard while inserting and locking the container in place under the vacuum.

Never place your hands between the vacuum and the refuse container while inserting and locking the refuse container in place under the vacuum.

Lock the container in place by means of the dedicated lever, using BOTH HANDS.



Warning!

Carefully read this use and maintenance manual before using the vacuum or carrying out maintenance operations.

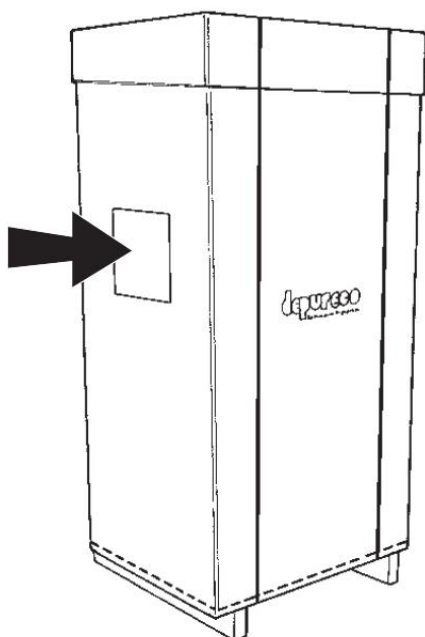

Warning!

Carefully read the instructions on the packaging before handling and unpacking the vacuum.





2.4 Residual risks

DEPURECO recommends complying with the instructions, procedures and recommendations in this manual and with the safety standards in force. DEPURECO also recommends using suitable personal protective equipment as well as the protection devices integrated in the vacuum.

The residual risks analysed on the vacuum and/or its components could be:

Electrical risks during maintenance due to the requirement to work on live parts

Pursuant to Italian Legislative Decree 81/08 – articles 80 to 87 – it is prohibited to operate on live parts, notwithstanding the exceptions set forth by said Legislative Decree.

Risks associated with incorrect use in presence of explosive and inflammable liquid substances

The vacuum must not be used in environments containing liquid substances or liquids that can evaporate at room temperature, inflammable powders and gas.

Risks related to operation in humid environments

Respect the limitations indicated in this manual, in section 1.5 “Authorised environmental conditions”.

Risk of crushing of upper limbs.

A safety pictogram on the vacuum warns about this hazard.

Risks of misinterpretation of safety pictograms

With reference to risk analysis and identification, DEPURECO has installed hazard labels on the vacuum, in compliance with the standards concerning graphical symbols.

The user must immediately replace any safety plate rendered illegible due to wear or damage.

Warning!



The removal of safety plates from the vacuum and/or its components and packaging is strictly prohibited.

DEPURECO shall not be held liable for the vacuum's safety in the event of failure to comply with this prohibition.

2.5 Applied Directives

The following directives apply to the vacuum cleaner described in this manual:

- 2006/42/EC Machinery Directive
- 2014/30/EU Electromagnetic Compatibility Directive

Reference standards, including their binding requirements, are managed through the DEPURECO Quality Management System.



3 HANDLING, UNPACKING AND INSTALLATION SECTION

3.1 Handling



Warning!

The instructions for transporting and unpacking the vacuum correctly are shown on the packaging as well.

The following instructions also indicate the operations to be undertaken should the vacuum need to be re-packed or unpacked after subsequent transportation.

Dimensions of packed vacuum cleaner:

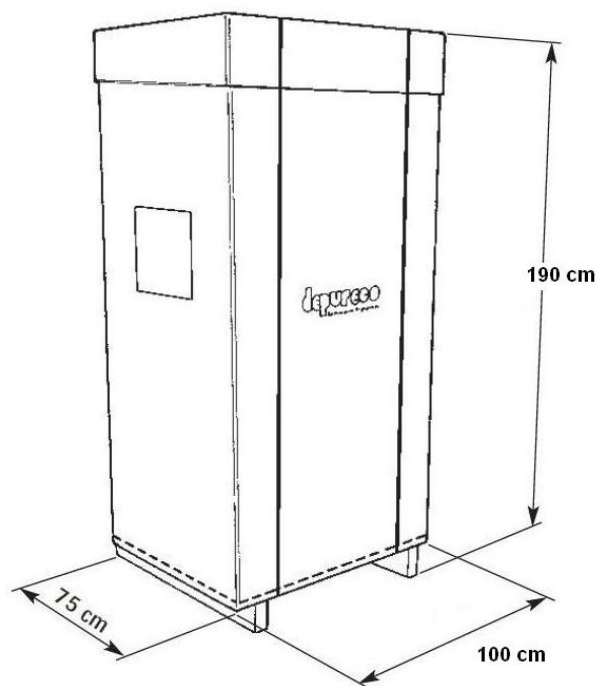

The vacuum must be lifted and handled only using a forklift whose load bearing capacity is suited to the weight.

When using a forklift, lift the load 200 mm off the ground and swing backwards.

Always keep the height of the working environment in mind when lifting loads.

Before starting any movement, ensure that the area is cleared and that there are no moving objects on the packaging. For lifting and handling, apply operating safety laws and normal instructions for fork-lift truck driving.



3.2 Unpacking

Cut and unwind the two packaging fixing belts.

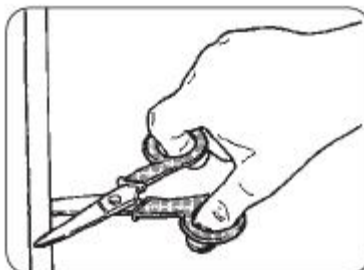

Remove the staples that fix the card packaging to the pallet with the aid of a screwdriver

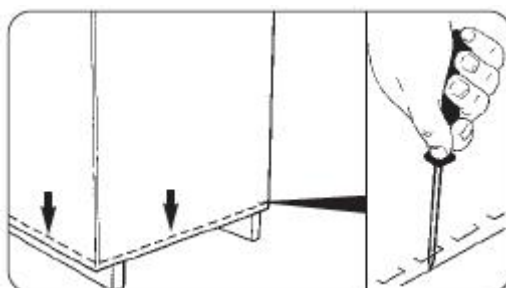

Remove the cardboard completely





loosen and remove the fastening screws and brackets from both sides

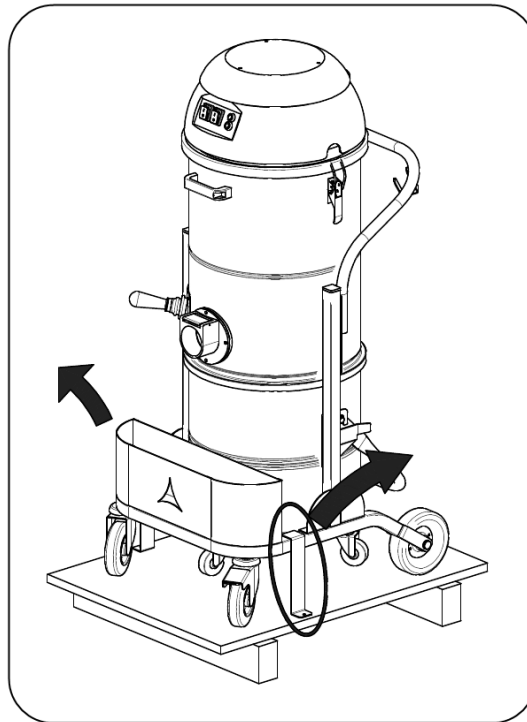

The cardboard packaging is recyclable and should be collected separately to prevent damaging the environment.



Warning!

Keep the pallet and the fastening brackets.

In the event of subsequent transport, the vacuum must be secured to the pallet using the same fastening system.



3.3 Installation



Caution!

Before installing the vacuum, it is important to carry out a thorough preventive visual inspection to identify any damage which may have occurred during transport.

In the event of one or more components being damaged, do not continue with installation and inform DEPURECO about the anomaly and agree upon action to be taken.

A suction filter is already fitted to the vacuum, unless specifically requested otherwise.

Fit the flexible tube fitted with the terminal on the appropriate suction nozzle and ensure that it is well affixed to the nozzle.

On the other end of the flexible tube, fit the accessory required for the type of suction

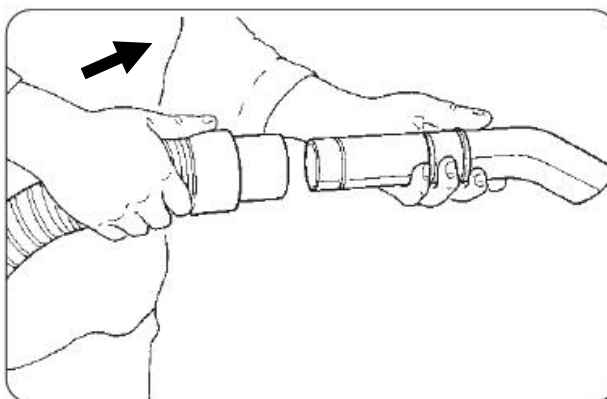

Note: the flexible tube and the relevant end-pieces and suction accessories are not included with the STANDARD model. Contact your dealer (or DEPURECO) for information regarding the various types of OPTIONALS that can be used on this specific model.



The following operation must be carried out by a qualified electrician.

Ensure that the power supply line corresponds to the voltage and frequency indicated on the identification plate and that it is efficiently earthed.

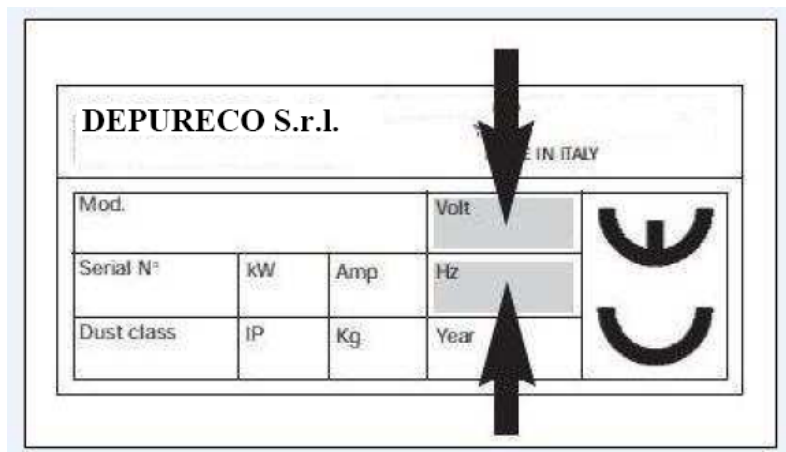

The vacuum cleaner's electrical current supply socket must be protected by a CE-marked circuit breaker.

Insert the plug (standard supply) into the socket.



Warning!

Do not insert the plug in the power supply socket with wet hands.

Do not use extension leads.



4. OPERATION SECTION

4.1 Description of controls

Warning!



The vacuum can be used solely by authorised personnel after having read these use and maintenance instructions.



The user of the equipment and the maintenance technician, who carry out operations on the vacuum, must be adequately educated, informed and trained, in compliance with the occupational safety standards in force and, during the various operations, must wear personal protective equipment (PPE), such as safety footwear, gloves, protective goggles, mask, etc. The user must comply with the provisions in force concerning extracted materials and their disposal.

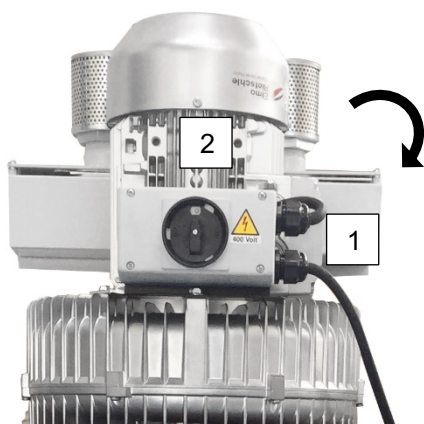

1. Position "I": Start suction
2. Position "O": Stop suction

4.2 Work cycle

Ensure that the power cord is intact and in perfect state.



Warning!

Before inserting the plug, ensure that the voltage of the power supply line corresponds to that indicated on the vacuum's identification plate.

Ensure that the power plug is inserted into the socket correctly.

Ensure that the hose is inserted properly and locked into the suction inlet.

Ensure that the waste collection container properly locked under the vacuum.



Block the vacuum using the lever on the swivel casters, as shown in the figure.

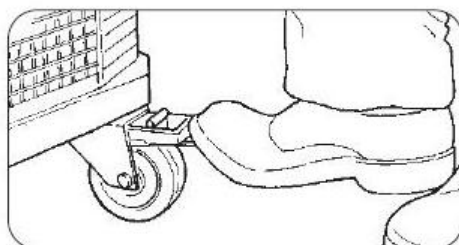

Warning!

Do not move the vacuum cleaner while it is in operation.

Hold the end of flexible tube with the chosen vacuum accessory.

Ensure that the inversion valve lever is position to SUCTION, and that the suction valve lever is set to ON

To start using the vacuum, turn the switch to “I”, to stop suction, rotate the switch to “O”

Check that the rotational direction is that indicated by the arrow in the diagram.

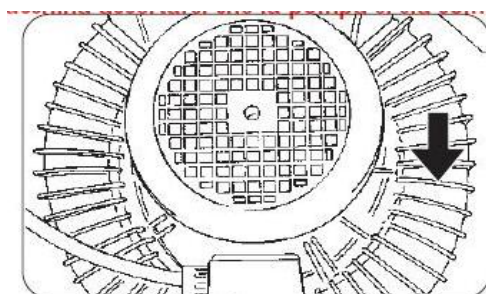

If the rotational direction of the motor is incorrect, use a screwdriver to remove the screw from the power supply plug and invert the two poles, rotating 180°.

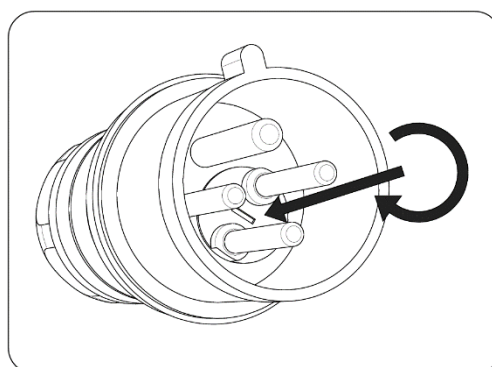



Caution!

Before switching the vacuum on again, check that the pump has stopped completely.

In order to move the machine, unlock the vacuum by using the lever on the caster wheels and use the handles on the rear.



Caution!

During operation, prevent the flexible hose from rolling up or kinking.



Warning!

If the vacuum is not working properly after having cleaned the filter, it may mean that the filter is clogged and needs to be replaced.



Warning!

During suction, do not move the suction valve lever to the OFF position.

4.3 Emptying the container with FLOW INVERSION VALVE

- Stop the suction motor by setting the I/O switch to “O”
- Block the vacuum using the lever on the swivel casters, as shown in the figure.

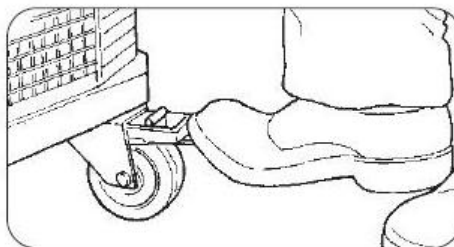



- Invert the flow by positioning the flow inversion valve lever (1) to the DISCHARGE position and the suction valve lever (2) set to OFF



1



2

- Start liquid expulsion by rotating the I/O switch to "I"
- Pull the trigger and start emptying the container



- Once emptying is complete, rotate the I/O switch to "O", reposition the flow inversion valve lever to SUCTION and the suction valve lever positioned to ON



Warning!

When emptying the container, do not use the vacuum with the suction valve lever set to ON.



4.4 Emptying the waste container



Warning!

During this operation, wear appropriate PPI (gloves, dust mask, goggles, etc.)

According to the amount and type of extracted material, it is important to periodically check the container and prevent it from overflowing.

To empty the container:

- Stop and disconnect the vacuum from mains power
- release the container by raising the lever

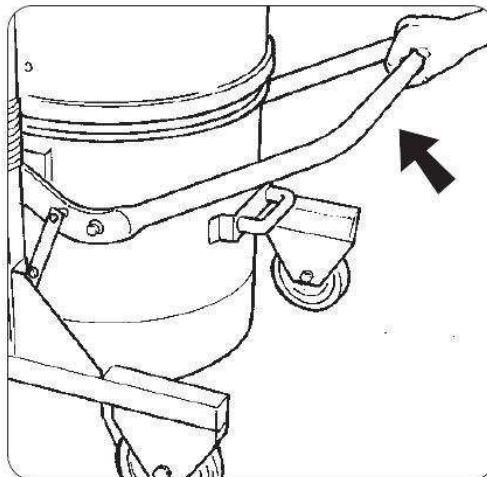

- remove the container from the vacuum, using the handle

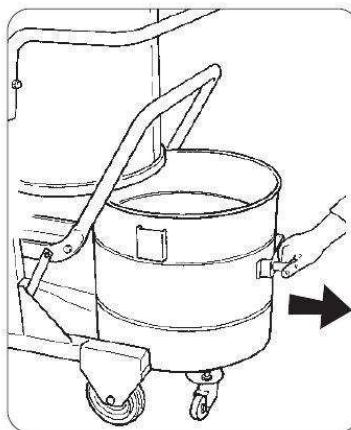

- Empty the container into the waste collection receptacle, ensuring it meets local waste handling regulations



- To empty the basket (1) in the container, simply remove it (by pulling upwards). When emptying the internal baskets, do not damage the floater inside.

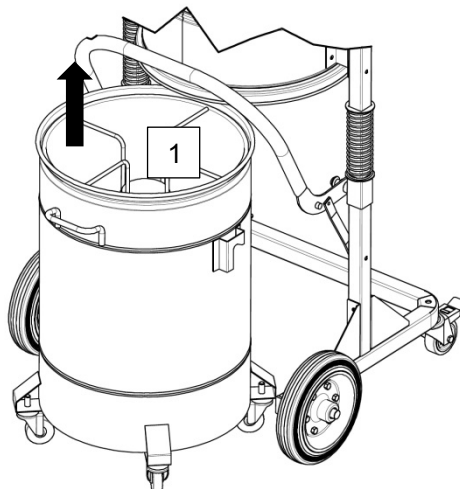

Warning!

If the container weighs more than 15 kg, seek assistance from someone else



Warning!

During this operation, wear appropriate PPI (gloves, dust mask, goggles, etc.)



Warning!

Waste must be disposed of in compliance with the standards in force in the country of use – for Italy with Legislative Decree 152/2006 and subsequent amendments.

In the event of use with class M, these must be collected in a special plastic bag.



4.5 Inserting and locking the waste container

- Correctly position the basket complete with floater inside the container.
- Insert the container underneath the vacuum, keeping the lever raised until the container is completely stopped against the buffers.

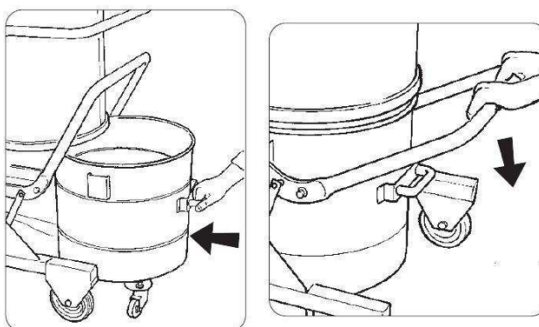

- Then completely lower the container locking lever.



Warning!

Upper limb crushing hazard!

Never put hands between the waste container and the vacuum cleaner during the locking phase.



Warning!

Do not use the vacuum if no basket and floater is fitted inside.

4.6 Storage - decommissioning

Remove the filter and clean it, empty the container and store the vacuum cleaner in a place free from atmospheric agents within a temperature range of 0° to 40°C, covering it with a nylon bag to prevent dust from collecting.



5. MAINTENANCE SECTION



Warning!

Special vacuum maintenance must be carried out solely by specialised technicians authorised by the DEPURECO dealer.

5.1 Informative notes

This section describes the checks and routine maintenance operations required to ensure proper vacuum operation.

Maximum reliability and minimum maintenance costs are the result of a planned maintenance and inspection schedule carefully followed throughout the entire lifespan of the vacuum.

Observe the set maintenance intervals and schedule the interventions according to specific requirements in relation with the vacuum production cycle.

Always use tools that are in perfect condition and that are specifically intended for the operation to be carried out; the use of inadequate or inefficient tools may cause serious damage.

Any other intervention required to eliminate faults or malfunctions must be expressly authorised by the manufacturer.

In these cases, always communicate the vacuum identification data - see para. 1.4 of this manual.

For significant repairs, refer to the authorised dealer, whose specialised personnel has the technological expertise and is always available for prompt interventions.

For user maintenance operations, the vacuum must be disassembled, cleaned and maintained, where possible, in such a way as to prevent hazards to the maintenance personnel and to third parties. Suitable precautions include decontamination prior to disassembly, forced filtered ventilation of the room where the equipment is disassembled, cleaning the maintenance area and wearing suitable personal protective equipment.

Once every three months (or more frequently, according to the operating cycle and the conditions of use), the manufacturer or a qualified technician must check the filters, ensuring that they are not damaged; the tightness of the air system and proper operation of the control devices.

Should maintenance operations or repairs be carried out, all contaminated objects must be adequately cleaned, placed in waterproof bags and disposed of in compliance with the regulations in force.



5.2 General safety regulations



Warning!

All the operations described above must be carried out with the plug disconnected from the socket.

Before starting any maintenance or cleaning operation, wear suitable PPE (protective clothing, goggles and/or gloves, etc.) according to the work to be done.



Place a sign on the vacuum with the message:

**“MACHINE UNDER MAINTENANCE
DO NOT START”**



Before returning to use, the whole system must be checked according starting procedures.

Run a few trial operating cycles after every maintenance operation to ensure proper machine operation.

Failure to observe these precautions can cause serious injury to personnel.

Maintenance operations must be carried out by trained technicians specialised in the following sectors:

- Mechanical maintenance
- Electrical maintenance

It is the Safety Manager's duty to ensure the professionalism and skills of these technicians.

Before starting any maintenance operation, the Safety Manager must:

- Keep unauthorised personnel out of the work area.



- ☞ Ensure that the necessary tools are in good conditions and readily available to the maintenance technician.
- ☞ Ensure that the maintenance technician is equipped with the personal protective equipment required for the specific operation (gloves, goggles, shoes, mask, etc.).
- ☞ Ensure that the maintenance technician has carefully read the instructions contained in this manual and knows the operation of the vacuum and its components perfectly well.

- Ensure that there is enough light and, if necessary, provide 24 Volt torches.



Before starting any maintenance operation, the Maintenance technician must:

- disconnect the electrical supply and lock the vacuum cleaner safety devices



Warning!

If absolutely necessary operating with the power turned on, pursuant to Italian Legislative Decree 81/08, the maintenance technician must maintain a safe distance, prepare reachable emergency stop buttons and never place hands in the discharge container.

At the end of the procedure and before returning to use, the maintenance technician must check that guards are functioning correctly and the protection devices are intact.

Operations on the motors or on other electrical components must only be carried out by the specially trained electrical maintenance technician authorised by the Safety Manager.



Warning!

After every maintenance operation, the Safety Manager must ensure the safety conditions of the vacuum and its protection devices.

Before every work shift

- Ensure that the power cord and plug are not damaged: replace the power cord immediately at the slightest sign of wear with one of the same type (refer to DEPURECO for information). This operation must be carried out only by a qualified electrician.
- Ensure the integrity of the safety symbols (pictograms) applied to the vacuum.
- Check that the waste container is empty and correctly locked under the vacuum cleaner.
- Check that the flexible suction hose and accessories are in good conditions.



Warning!

The flexible suction tube, if perforated, reduces the suction power and releases dust into the surrounding environment.



5.3 Replacing the oil mist filter

To replace the filter, proceed as follows:

- Stop suction by setting the I/O switch to “O”
- Remove the vacuum cleaner plug from power supply socket



Warning!

Wear appropriate PPE (dust mask, latex gloves, goggles, etc.).

- Lock the vacuum using the appropriate brakes

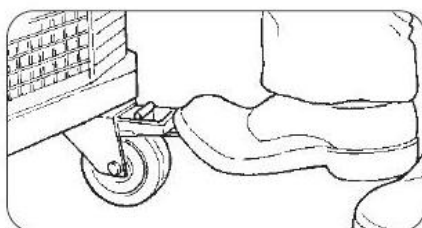

- Disconnect the power cable. Disconnect the tube that connects the motor to the filter chamber.
- Loosen the hooks (1) that lock the head (2) and lift using the handles, resting on a work surface, paying attention to not damage electrical cables and tubes attached to it.

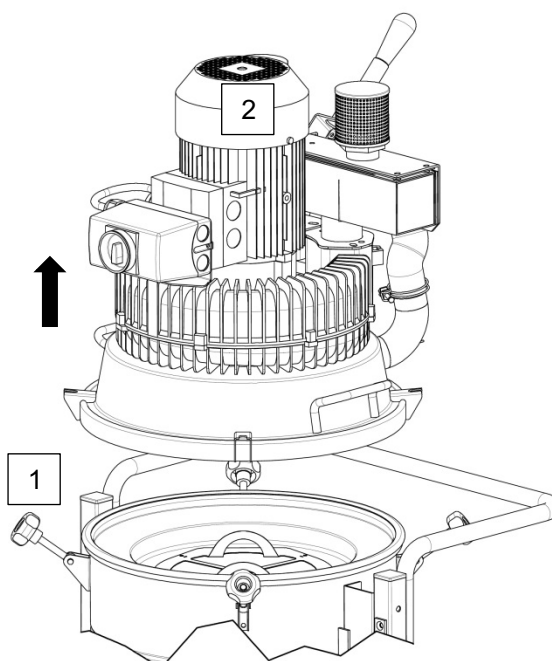



- Lift and unscrew the filter (3) from its housing (4)

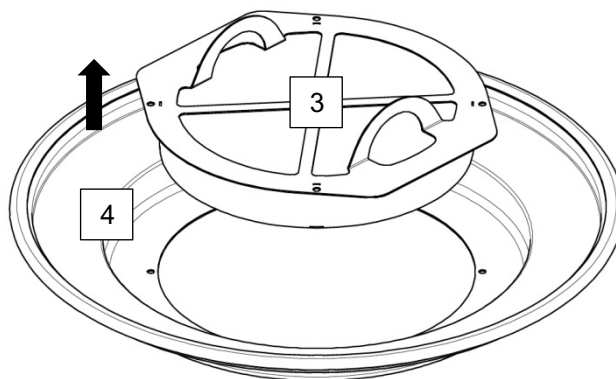

- Remove the filter, put it in a plastic bag, seal it and **dispose of according to applicable laws** for the type of material collected.

To fit the new filter, proceed as follows:

- Screw the new filter into its housing. Replace the filter chamber support.
- With help from a second person, replace the vacuum head on top of the filter chamber,
- taking care to tighten the hooks of the chamber up to the notches on the head of the vacuum.

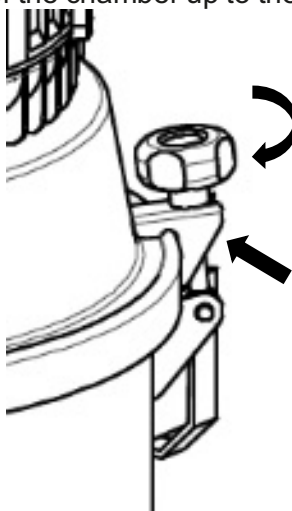

- Connect the vacuum to the electrical power supply.
- Turn the vacuum on and check that it is working correctly.

ONLY USE ORIGINAL DEPURECO FILTERS



5.4 Troubleshooting

FAULT DETECTED	POSSIBLE CAUSE	SOLUTION RECOMMENDED
The vacuum cleaner will not start	No power supply Magnetothermic main switch tripped	Check if there is power at the plug socket Check the condition of the plug and the power cable Reset the magnetothermic switch Contact DEPURECO technical assistance
Irregular suction	Clogged filter	Clean the oil mist filter, if insufficient, replace
	Clogged suction tube	Check suction tube and clean it.
Excessive noise from motor	Faulty pump	Contact DEPURECO technical assistance



5.5 Scrapping



When scrapping, in order to prevent harm to the environment, all of the vacuum's components must be disposed of responsibly, in suitable waste handling centres that comply with applicable legislation - In Italy, Legislative Decree 152/2006 and subsequent amendments. .

Before scrapping the machine, the plastic and rubber materials must be separated from the electrical material.

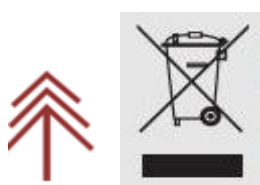

Correct disposal of the product (electrical and electronic equipment waste)

The electrical and electronic parts of this product must be disposed of in compliance with Italian Legislative Decree 151/2005 and subsequent amendments. (Directive 2002/96/EC on WEEE - Waste Electrical and Electronic Equipment)



The parts of the vacuum made of plastic material, aluminium and steel can be recycled in appropriate centres.



*In caso di dubbi non interpretate!
Telefonate immediatamente al Vostro rivenditore.*

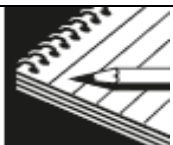

MAINTENANCE LOG

INTERVENTION 1

Date

Technical Assistance

Type of Works

Signed

INTERVENTION 2

Date

Technical Assistance

Type of Works

Depureco Industrial Vacuums Srl
Società soggetta a direzione e coordinamento COFISE spa

C.F. e P.I. 02258610357

Registro Imprese di Torino

R.E.A. TO - 1149668

Capitale Sociale: € 25.000 i.v.

Signed



MAINTENANCE LOG

INTERVENTION 3

Date

Technical Assistance

Type of Works

Signed