

USER MANUAL AND MAINTENANCE



SERIES ECOBULL | ECOBULL ACD **ECOBULL H ACD INERT | ECOBULL XM DEX 1/3D - 1/2D** **ECOBULL DEX 1/3D | ECOBULL DEX 1/2D** **ECOBULL DEX 3/3G | ECOBULL DEX 1/3D - 1/2D INERT**

TRANSLATION OF ORIGINAL INSTRUCTIONS

Rev. 01 dated January 1, 2026

Depureco Industrial Vacuums Srl

Company subject to management and coordination COFISE spa

Via Venezia, 32 - 10088 Volpiano (TO)

Tel. +39 011 98.59.117

Fax. +39 011 98.59.326

www.depureco.com

depureco@depureco.com

depureco@documentipec.com

C.F. and P.I. 02258610357 - **Capital stock:** € 25,000 i.v.

Turin Business Register - **R.E.A.** TO-1149668

Registration **WEEE** No. IT18090000010711



INDEX

1. INFORMATION SECTION	11
1.1. Preface	11
1.2. Identification of major parts	13
1.3. Optional parts	15
1.4. Manufacturer identification data	15
1.5. Name plate	15
1.6. Intended uses	16
1.7. ATEX Marking	20
1.8. Allowable environmental conditions	20
1.9. Noise level	21
1.10. Technical Data	22
1.11. Warranty	28
2. SAFETY SECTION	29
2.1. Safety information	29
2.2. Safety prescriptions	29
2.3. ATEX Safety Instructions	32
2.4. Safety plates and symbols	35
2.5. Residual risks	37
2.6. Directives and standards applied	38
3. HANDLING, UNPACKING AND INSTALLATION SECTION	39
3.1. Handling	39
3.2. Unpacking	40
3.3. Installation	41
4. OPERATION SECTION	43
4.1. Command description	43
4.2. Duty cycle	44
4.3. Air speed control	46
4.4. Filter cleaning cycle	46
4.5. Emptying the container	49
4.6. Inserting and locking the container	53
4.7. Storage - decommissioning	54



5. MAINTENANCE SECTION	55
5.1. Informational Notes	55
5.2. General safety standards	55
5.3. Primary filter replacement	57
5.4. HEPA filter replacement	64
5.5. Inerting kit filter maintenance and replacement	66
5.6. If something doesn't work	68
5.7. Scrapping	68



DECLARATION OF CONFORMITY FOR NON ATEX VERSIONS

ECOBULL M | ECOBULL T | ECOBULL PLUS | ECOBULL M ACD | ECOBULL T ACD | ECOBULL PLUS ACD | ECOBULL M H ACD INERT | ECOBULL T H ACD INERT



DECLARATION OF CONFORMITY

The construction company:

DEPURECO INDUSTRIAL VACUUMS S.r.l. – Via Venezia, 32 – 10088 Volpiano (TO) – ITALY | Tel. +39 011 98 59 117 – Fax + 39 011 98 59 326 – C.F. | 02258610357

E-mail: depureco@depureco.com – www.depureco.com

says

Under your responsibility that the vacuum cleaner model described in this manual



complies with the essential safety requirements of the Machinery Directive 2006/42/EC, the Electromagnetic Compatibility Directive 2014/30/EU and the ROHS Directive 2011/65/EU - ROHS - on the restriction of the use of certain hazardous substances in electrical and electronic equipment.

Compliance has been verified according to the requirements of the standards or regulatory documents:

EN 60335-1

EN IEC 61000-3-2:2019

EN IEC 63000:2018

IEC 60335-2-69

EN 55014-2:2015

The standards used as a reference for the design, construction and testing of the vacuum cleaner are listed in the technical file submitted to the technical office DEPURECO S.r.l.

Production control was carried out by Notified Body No . 0474 RINA Services S.p.a.

This declaration loses its validity in the event of modifications to the vacuum cleaner carried out without the manufacturer's authorisation.

First published: June 15, 2019
Revision 01: October 16, 2023
Revision 02: April 26, 2024
Revision 03: January 1, 2026

The Legal Representative
Marco Devincentis

Depureco Industrial Vacuums Srl
Società soggetta a direzione e coordinamento CORISE spa

PERFORMANCE ON VACUUM SINCE 1972

Via Venezia, 32 - 10088 Volpiano (TO)
Tel. +39 011 98.59.117
Fax +39 011 98.59.326

www.depureco.com
depureco@depureco.com
depureco@documentipec.com

C.F. e P.I. 02258610357
Registro Imprese di Torino - R.E.A. TO-1149668
Capitale Sociale: € 25.000 i.v.



DECLARATION OF CONFORMITY FOR ATEX VERSIONS

ECOBULL M ATEX SP 3D | ECOBULL T ATEX SP 3D | ECOBULL PLUS ATEX SP 3D



DECLARATION OF CONFORMITY

The construction company:

DEPURECO INDUSTRIAL VACUUMS S.r.l. – Via Venezia, 32 – 10088 Volpiano (TO) – ITALY | Tel. +39

011 98 59 117 – Fax + 39 011 98 59 326 – C.F. | **02258610357**

E-mail: depureco@depureco.com – www.depureco.com

says

Under your responsibility that the vacuum cleaner model described in this manual

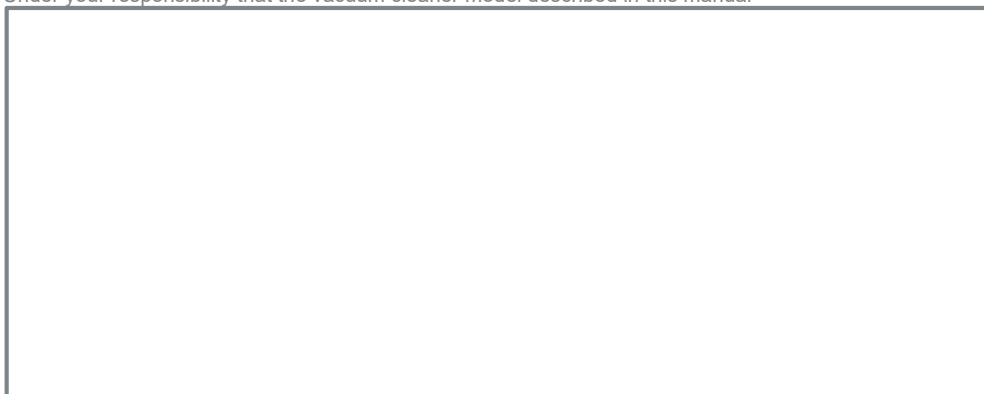

complies with the essential safety requirements of the **Machinery Directive 2006/42/EC**, the Electromagnetic Compatibility Directive **2014/30/EU**, Directive **2011/65/EU - ROHS** - on the restriction of the use of certain hazardous substances in electrical and electronic equipment, as well as the **ATEX Directive 2014/34/EU**.

Compliance has been verified according to the requirements of the standards or regulatory documents:

UNI EN 1127-1:2019
EN 60079-0:2018

UNI EN ISO 80079-36:2016
UNI EN 17348:2022

UNI EN ISO 80079-37:2016
EN IEC 62784:2018

MARKING: **CE**



II 3 G/D Ex h IIIB T160°C Gc/Dc

The standards used as a reference for the design, construction and testing of the vacuum cleaner are listed in the technical file submitted to the technical office DEPURECO S.r.l.

This declaration loses its validity in the event of modifications to the vacuum cleaner carried out without the manufacturer's authorisation.

First published: June 15, 2019

Revision 01: October 16, 2023

Revision 02: January 01, 2026

The Legal Representative
CEO Marco Devincents

Depureco Industrial Vacuums Srl

Company subject to the management and coordination of
the COFISE spa

PERFORMANCE ON VACUUM SINCE 1972

Via Venezia, 32 - 10088 Volpiano (TO)
Tel. +39 011 98.59.117
Fax +39 011 98.59.326

www.depureco.com
depureco@depureco.com
depureco@documentipec.com

C.F. and P.I. 02258610357
Turin R.E.A. **Business Register** TO-1149668
Share capital: €25,000 IV.



DECLARATION OF CONFORMITY FOR ATEX VERSIONS

ECOBULL XM M DEX 1/3D | ECOBULL XM T DEX 1/3D | ECOBULL M DEX 1/3D | ECOBULL T DEX 1/3D | ECOBULL PLUS DEX 1/3D | ECOBULL M DEX 1/3D INERT | ECOBULL T DEX 1/3D INERT



DECLARATION OF CONFORMITY

The construction company:

DEPURECO INDUSTRIAL VACUUMS S.r.l. – Via Venezia, 32 – 10088 Volpiano (TO) – ITALY | Tel. +39 011 98 59 117 – Fax + 39 011 98 59 326 – C.F. | 02258610357

E-mail: depureco@depureco.com – www.depureco.com

says

Under your responsibility that the vacuum cleaner model described in this manual



complies with the essential safety requirements of the **Machinery Directive 2006/42/EC**, the Electromagnetic Compatibility Directive **2014/30/EU**, Directive **2011/65/EU - ROHS** - on the restriction of the use of certain hazardous substances in electrical and electronic equipment, as well as the **ATEX Directive 2014/34/EU**.

Compliance has been verified according to the requirements of the standards or regulatory documents:

UNI EN 1127-1:2019
EN 60079-0:2018

UNI EN ISO 80079-36:2016
UNI EN 17348:2022

UNI EN ISO 80079-37:2016

MARKING:   **II 1/3 D Ex h IIIC T160°C Da/Dc**

TÜV Nord has issued the EU type-certificate: TÜV CY 25 ATEX 0207500 X

Production control was carried out by Notified Body No. RINA 0474

The standards used as a reference for the design, construction and testing of the vacuum cleaner are listed in the technical file submitted to the technical office DEPURECO S.r.l.

This declaration loses its validity in the event of modifications to the vacuum cleaner carried out without the manufacturer's authorisation.

First published: 01 January 2026

The Legal Representative
CEO Marco Devincentis

Depureco Industrial Vacuums Srl
Company subject to the management and coordination of
the COFISE spa

PERFORMANCE ON VACUUM SINCE 1972

Via Venezia, 32 - 10088 Volpiano (TO)
Tel. +39 011 98.59.117
Fax +39 011 98.59.326

www.depureco.com
depureco@depureco.com
depureco@documentipeccom

C.F. and P.I. 02258610357
Turin R.E.A. **Business Register** TO-1149668
Share capital: €25,000 IV.



DECLARATION OF CONFORMITY FOR ATEX VERSIONS

ECOBULL XM M DEX 1/2D | ECOBULL XM T DEX 1/2D | ECOBULL M DEX 1/2D | ECOBULL T DEX 1/2D | ECOBULL PLUS DEX 1/2D | ECOBULL M DEX 1/2D INERT | ECOBULL T DEX 1/2D INERT



DECLARATION OF CONFORMITY

The construction company:

DEPURECO INDUSTRIAL VACUUMS S.r.l. – Via Venezia, 32 – 10088 Volpiano (TO) – ITALY | Tel. +39

011 98 59 117 – Fax + 39 011 98 59 326 – C.F. | 02258610357

E-mail: depureco@depureco.com – www.depureco.com

says

Under your responsibility that the vacuum cleaner model described in this manual



complies with the essential safety requirements of the **Machinery Directive 2006/42/EC**, the Electromagnetic Compatibility Directive **2014/30/EU**, Directive **2011/65/EU - ROHS** - on the restriction of the use of certain hazardous substances in electrical and electronic equipment, as well as the **ATEX Directive 2014/34/EU**.

Compliance has been verified according to the requirements of the standards or regulatory documents:

UNI EN 1127-1:2019

UNI EN ISO 80079-36:2016

UNI EN ISO 80079-37:2016

EN 60079-0:2018

UNI EN 17348:2022

MARKING:   **II 1/2 D Ex h IIIC T160°C Da/Db**

TÜV Nord has issued the EU type-certificate: TÜV CY 25 ATEX 0207500 X

Production control was carried out by Notified Body No. RINA 0474

The standards used as a reference for the design, construction and testing of the vacuum cleaner are listed in the technical file submitted to the technical office DEPURECO S.r.l.

This declaration loses its validity in the event of modifications to the vacuum cleaner carried out without the manufacturer's authorisation.

First published: 01 January 2026

The Legal Representative
CEO Marco Devincensis

Depureco Industrial Vacuums Srl
Company subject to the management and coordination of
the COFISE spa

PERFORMANCE ON VACUUM SINCE 1972

Via Venezia, 32 - 10088 Volpiano (TO)
Tel. +39 011 98.59.117
Fax +39 011 98.59.326

www.depureco.com
depureco@depureco.com
depureco@documentipec.com

C.F. and P.I. 02258610357
Turin R.E.A. **Business Register** TO-1149668
Share capital: €25,000 IV.



DECLARATION OF CONFORMITY FOR ATEX VERSIONS

ECOBULL M DEX 3/3G | ECOBULL T DEX 3/3G | ECOBULL PLUS DEX 3/3G



DECLARATION OF CONFORMITY

The construction company:

DEPURECO INDUSTRIAL VACUUMS S.r.l. – Via Venezia, 32 – 10088 Volpiano (TO) – ITALY | Tel. +39 011 98 59 117 – Fax + 39 011 98 59 326 – C.F. | 02258610357

E-mail: depureco@depureco.com – www.depureco.com

says

Under your responsibility that the vacuum cleaner model described in this manual



complies with the essential safety requirements of the **Machinery Directive 2006/42/EC**, the Electromagnetic Compatibility Directive **2014/30/EU**, Directive **2011/65/EU - ROHS** - on the restriction of the use of certain hazardous substances in electrical and electronic equipment, as well as the **ATEX Directive 2014/34/EU**.

Compliance has been verified according to the requirements of the standards or regulatory documents:

UNI EN 1127-1:2019
EN 60079-0:2018

UNI EN ISO 80079-36:2016
UNI EN 17348:2022

UNI EN ISO 80079-37:2016

MARKING: **CE**



II 3/3 G Ex h IIB+H2 T4 Gc/Gc

TÜV Nord has issued the EU type-certificate: **TÜV CY 25 ATEX 0207497 X**

Production control was carried out by Notified Body No. **RINA 0474**

The standards used as a reference for the design, construction and testing of the vacuum cleaner are listed in the technical file submitted to the technical office DEPURECO S.r.l.

This declaration loses its validity in the event of modifications to the vacuum cleaner carried out without the manufacturer's authorisation.

First published: 01 January 2026

The Legal Representative
CEO Marco Devincentis

Depureco Industrial Vacuums Srl
Company subject to the management and coordination of
the CORSE spa

PERFORMANCE ON VACUUM SINCE 1972

Via Venezia, 32 - 10088 Volpiano (TO)
Tel. +39 011 98.59.117
Fax +39 011 98.59.326

www.depureco.com
depureco@depureco.com
depureco@documentipec.com

C.F. and P.I. 02258610357
Turin R.E.A. **Business Register** TO-1149668
Share capital: €25,000 IV.





1. INFORMATION SECTION

IMPORTANT - The term and logo DEPURECO in this document refer to and are the property of DEPURECO INDUSTRIAL VACUUMS S.r.l.

This document is the exclusive property of DEPURECO S.r.l. Therefore, its reproduction by any means (graphic, computer, etc.), partial or total, is prohibited without the authorization of the Company Management.

1.1. PREFACE

Dear Customer

Thank you for choosing DEPURECO and congratulations on selecting a DEPURECO vacuum cleaner from the ECOBULL | ECOBULL ACD | ECOBULL H ACD INERT | ECOBULL XM DEX 1/3D - 1/2D series. ECOBULL DEX 1/3D | ECOBULL DEX 1/2D | ECOBULL DEX 3/3G | ECOBULL DEX 1/3D - 1/2D INERT series.

We have prepared this manual to enable you to fully appreciate the quality of this machine.

We recommend reading it thoroughly before using the product for the first time.

It contains important information, tips and warnings for the use and maintenance of the vacuum cleaner that will help you take full advantage of the technical features of your machine.

It is recommended to read carefully the messages, warnings and directions, preceded by the symbols:



For the safety of people.



For the integrity of the aspirator.



For the preservation of the environment.

This manual describes the following models:

- ECOBULL M
- ECOBULL T
- ECOBULL PLUS
- ECOBULL M ACD
- ECOBULL T ACD
- ECOBULL PLUS ACD
- ECOBULL M H ACD INERT
- ECOBULL T H ACD INERT
- ECOBULL XM M DEX 1/3D
- ECOBULL XM T DEX 1/3D
- ECOBULL XM M DEX 1/2D
- ECOBULL XM T DEX 1/2D
- ECOBULL M DEX 1/3D
- ECOBULL T DEX 1/3D
- ECOBULL PLUS DEX 1/3D
- ECOBULL M ATEX SP 3D
- ECOBULL T ATEX SP 3D
- ECOBULL PLUS ATEX SP 3D
- ECOBULL M DEX 1/2D
- ECOBULL T DEX 1/2D
- ECOBULL PLUS DEX 1/2D
- ECOBULL M DEX 3/3G
- ECOBULL T DEX 3/3G
- ECOBULL PLUS DEX 3/3G
- ECOBULL M DEX 1/3D INERT
- ECOBULL T DEX 1/3D INERT
- ECOBULL M DEX 1/2D INERT
- ECOBULL T DEX 1/2D INERT



Machines are classified according to their degree of dust filtration efficiency:

- L (light risk): in vacuum cleaners with a class L filter, the maximum degree of dust penetration is less than 1 percent (Degree of penetration < 1 %);
- M (medium risk): in vacuum cleaners with M filter, the maximum degree of dust particle penetration is less than 0.1 percent (Degree of penetration < 0.1 %);
- H (high hazard): in vacuum cleaners with filter H, the maximum degree of dust particle penetration is less than 0.005% (Degree of penetration < 0.005 %); This vacuum cleaner is designed to perform vacuuming, cleaning and collection operations of solid materials (dust and processing residues).

This specific model has undergone strict testing to ensure maximum reliability; its smooth operation and longevity will depend on good maintenance and careful use.

This manual is an integral part of the vacuum cleaner and must accompany it, until it is scrapped. In case of loss or damage, a replacement copy should be requested from DEPURECO INDUSTRIAL VACUUMS S.r.l. (hereafter referred to simply as DEPURECO).

The technical information contained in this manual is the property of DEPURECO and should be considered confidential in nature.

Reproduction, even in part, of the graphic design, text and illustrations is prohibited by law.

Some details depicted in the illustrations in this manual may differ from those in your vacuum cleaner, as some components may have been removed in order to ensure maximum clarity of the illustrations.

The topics covered in this manual, are those expressly required by the Machinery Directive 2006/42/EC and the technical data given are derived from the technical file stored at DEPURECO.

In compliance with Regulation 1907/2006/EC (REACH), DEPURECO declares that its products do not contain any of the substances, so-called substances of very high concern - SVHC i.e. Substances of Very High Concern - listed in the Candidate List.

This manual can be accessed via the QR code affixed to the vacuum cleaner or via the website www.depureco.com. Alternatively, contact the manufacturer Depureco. The manual should be made available to all personnel responsible for operating and maintaining the vacuum cleaner. For any dispute, the Court of Turin (Italy) shall have jurisdiction.

The QR code with the manual must accompany the vacuum cleaner in case of resale!

1.2. IDENTIFICATION OF MAJOR PARTS

ECOBULL
ECOBULL ACD
ECOBULL DEX 1/3D
ECOBULL DEX 1/2D

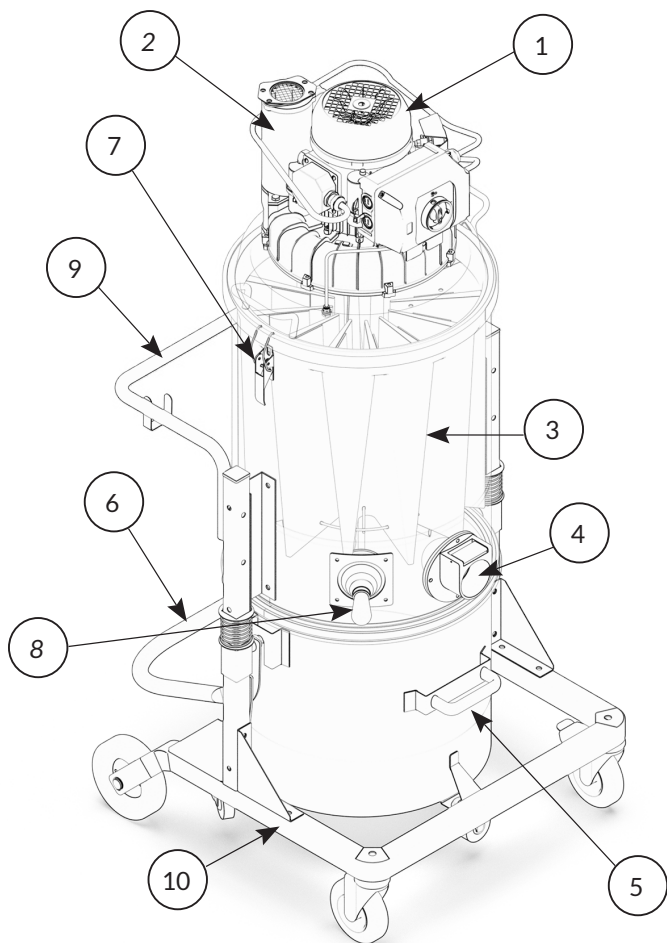

ECOBULL H ACD INERT
ECOBULL DEX 1/3D INERT
ECOBULL DEX 1/2D INERT

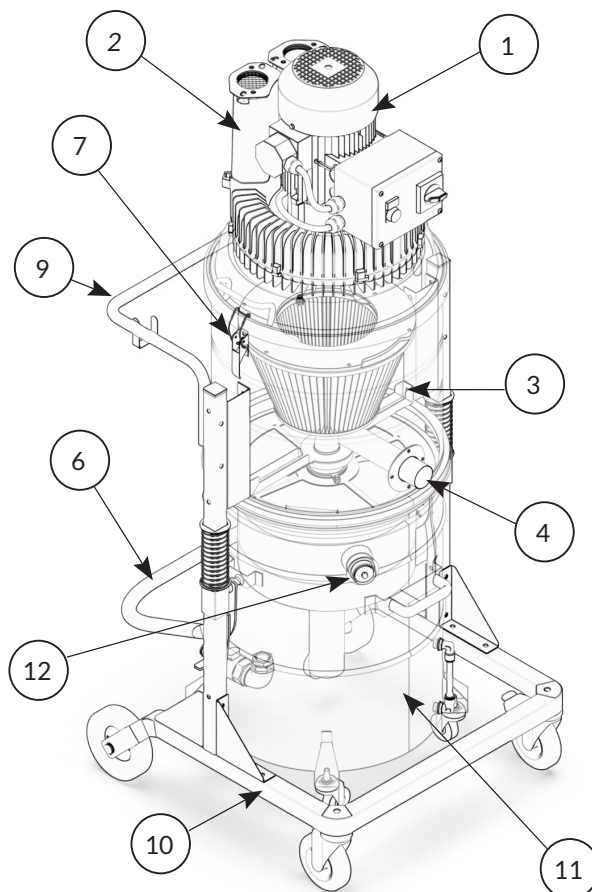

1. Vacuum head with on/off controls
2. Silencer
3. Filter chamber
4. Suction nozzle
5. Dust/debris collection container
6. Lever for releasing and attaching the container
7. Closing hooks
8. Lever for manual filter shaking
9. Handle for handling the vacuum cleaner
10. Base
11. Inert liquid container with level indicator
12. Hydrogen safety valve
13. JetClean® cleaning plate
14. JetClean® Cleaning Damper

ECOBULL XM DEX 1/3D ECOBULL XM DEX 1/2D

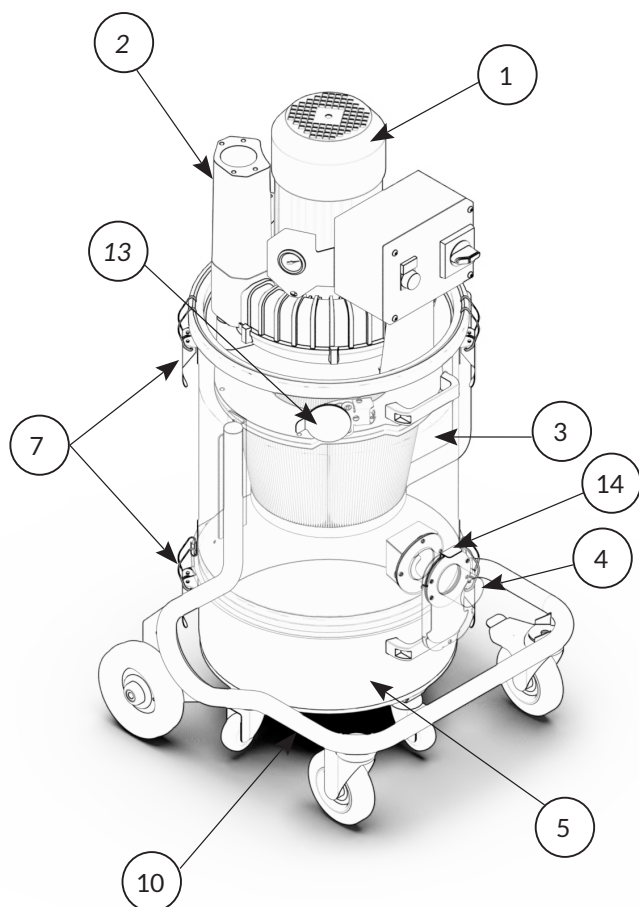

ECOBULL DEX 3/3G

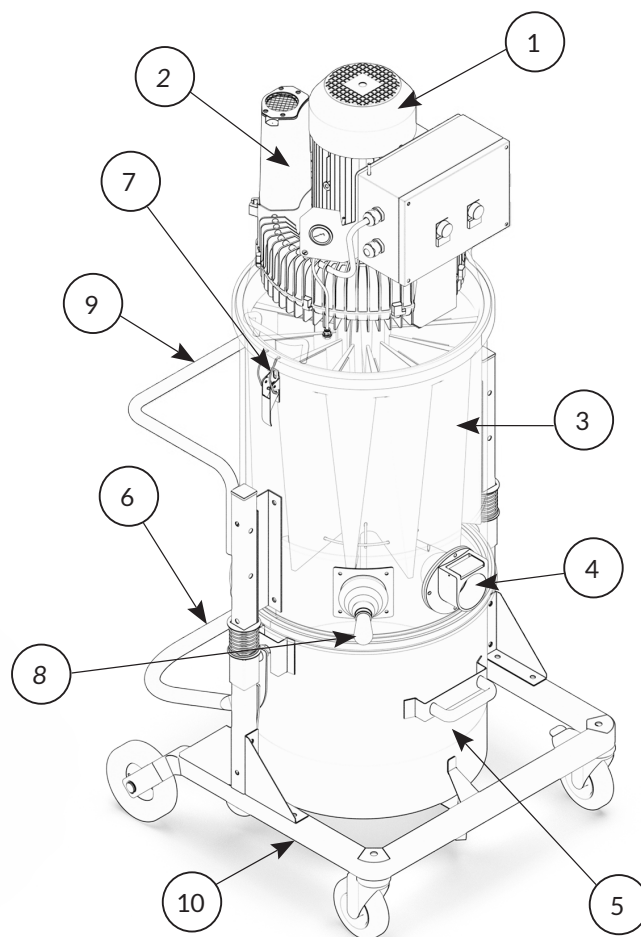

1. Vacuum head with on/off controls
2. Silencer
3. Filter chamber
4. Suction nozzle
5. Dust/debris collection container
6. Lever for releasing and attaching the container
7. Closing hooks
8. Lever for manual filter shaking
9. Handle for handling the vacuum cleaner
10. Base
11. Inert liquid container with level indicator
12. Hydrogen safety valve
13. JetClean® cleaning plate
14. JetClean® Cleaning Damper

1.3. OPTIONAL PARTS

Depending on the vacuum cleaner's application, a wide range of other optional accessories is available from DEPURECO.

1.4. MANUFACTURER IDENTIFICATION DATA

Depureco Industrial Vacuums S.r.l.

Via Venezia 32, 10088, Volpiano (TO), Italy

tel: +39 011 98 59 117 fax: +39 011 98 59 326 P.I. 02258610357

e-mail: depureco@depureco.com

website: www.depureco.com

1.5. NAME PLATE

ECOBULL M | ECOBULL T | ECOBULL PLUS | ECOBULL M ACD | ECOBULL T ACD | ECOBULL PLUS ACD | ECOBULL M H ACD INERT | ECOBULL T H ACD INERT

Model	ECOBULL			 DEPURECO Via Venezia, 32 10088 Volpiano Tel. +39 011 9859117 Fax +39 011 9859326
Serial No.	M25 - XXXX	Year	XX/2025	
Max power	3,0 kW - 6,6 A			
Max voltage	400V 3 ~ ac 50 Hz			
Dust class	M	Weight	75 Kg	
T. ambient	-15 C° / + 40 C°			
IP Protection 55				 0474  
www.depureco.com MADE IN ITALY				

ECOBULL M ATEX SP 3D | ECOBULL T ATEX SP 3D | ECOBULL PLUS ATEX SP 3D

Model	ECOBULL SP			 DEPURECO Via Venezia, 32 10088 Volpiano Tel. +39 011 9859117 Fax +39 011 9859326
Serial No.	M25 - XXXX	Year	XX/2025	
Max power	XX,X kW - XX,X A			
Max voltage	400V 3 ~ ac 50 Hz			
Dust class	M	Weight	XX Kg	
T. ambient	-15 C° / + 40 C°			
IP Protection 65				
 II 3 D Ex h IIIC T160°C Dc				
www.depureco.com MADE IN ITALY				



ECOBULL XM M DEX 1/3D | ECOBULL XM T DEX 1/3D | ECOBULL M DEX 1/3D | ECOBULL T DEX 1/3D | ECOBULL PLUS DEX 1/3D | ECOBULL M DEX 1/3D INERT | ECOBULL T DEX 1/3D INERT

Model	ECOBULL DEX			 DEPURECO Via Venezia, 32 10088 Volpiano Tel. +39 011 9859117 Fax +39 011 9859326
Serial No.	M25 - XXXX	Year	XX/2025	
Max power	XX,X kW - XX,X A			
Max voltage	400V 3 ~ ac 50 Hz			
Dust class	M	Weight	XX Kg	
T. ambient	-15 C° / + 40 C°			
IP Protection 65				 0474
 II 1/3 D Ex h IIIC T160°C Da/Dc				
Tech file: FP27EX TÜV CY 25 ATEX 0207500 X www.depureco.com MADE IN ITALY				

ECOBULL XM M DEX 1/2D | ECOBULL XM T DEX 1/2D | ECOBULL M DEX 1/2D | ECOBULL T DEX 1/2D | ECOBULL PLUS DEX 1/2D | ECOBULL M DEX 1/2D INERT | ECOBULL T DEX 1/2D INERT

Model	ECOBULL DEX			
Serial No.	M25 - XXXX	Year	XX/2025	Via Venezia, 32 10088 Volpiano Tel. +39 011 9859117 Fax +39 011 9859326
Max power	XX,X kW - XX,X A			
Max voltage	400V 3 ~ ac 50 Hz			
Dust class	M	Weight	XX Kg	IP Protection 65
		II 1/2 D Ex h IIIC T160°C Da/Db		 0474
T. ambient	-15 C° / + 40 C°		Tech file: FP27EX	TÜV CY 25 ATEX 0207500 X
			www.depureco.com	MADE IN ITALY

ECOBULL M DEX 3/3G | ECOBULL T DEX 3/3G | ECOBULL PLUS DEX 3/3G

Model	ECOBULL DEX			
Serial No.	MXX - XXXX	Year	XX/20XX	Via Venezia, 32 10088 Volpiano Tel. +39 011 9859117 Fax +39 011 9859326
Max power	XX,X kW - XX,X A			
Max voltage	400V 3 ~ ac 50 Hz			
Dust class	M	Weight	XX Kg	IP Protection 65
		II 3/3 G Ex h IIB+H2 T4 Gc/Gc		 0474
T. ambient	-15 C° / + 40 C°		Tech file: FP29EX	TÜV CY 25 ATEX 0207497 X
			www.depureco.com	MADE IN ITALY

1.6. INTENDED USES

ECOBULL M | ECOBULL T | ECOBULL PLUS

These vacuum cleaners are manufactured in accordance with Directive 2006/42/EC, are designed for use by a single operator, and are intended for:

- to industrial use, such as in manufacturing plants or warehouses;
- To dry/wet cleaning of floors or walls;
- To the suction of wet or damp substances;
- To the extraction of dry, non-combustible dust.

WARNING

Where there is the presence of combustible dust and/or flammable gases in the workplace, it is the responsibility of the Employer to make the classification of the area and choose a Category machine (as defined in Directive 2014/34/EU).

Any other use is considered **NON-COMPLIANT** with the intended use.

ECOBULL M ACD | ECOBULL T ACD | ECOBULL PLUS ACD

These vacuum cleaners are manufactured in accordance with Directive 2006/42/EC, are designed for use by a single operator, and are intended for:

- to industrial use, such as in manufacturing plants or warehouses;
- vacuuming dry, flammable, deposited, and hazardous dust (dust class according to EN 60335-2-69);
- Vacuum non-explosive dust;
- Vacuum flammable dusts of all explosion classes (except dusts with minimum ignition energy MIE < 3 mJ);



- flammable dust from a zone 22 if the equipment is installed outside potentially explosive areas.

The device **NOT** is suitable for:

- Vacuum ignition sources and dust with a glow temperature $\leq 190\text{ }^{\circ}\text{C}$;
- Inhale explosive substances or equivalent, explosive vapor-air mixtures, as well as Mg dust;
- Vacuuming of flammable fluids (flammable, easily flammable, highly flammable according to the Dangerous Substances Directive 67/ 548/EEC) (flash point less than $55\text{ }^{\circ}\text{C}$), as well as mixtures of flammable powders with flammable fluids;
- Aspirate mixtures of flammable fluids and flammable dusts;
- Inhale glowing or hot particles to avoid causing a fire or explosion.
- Be connected to a machine that generates dust.

WARNING

Where there is the presence of combustible dust and/or flammable gases in the workplace, it is the responsibility of the Employer to make the classification of the area and choose a Category machine (as defined in Directive 2014/34/EU).

Any other use is considered **NON-COMPLIANT** with the intended use.

WARNING

Use only silicone-based inerting oil with high dielectric strength (approximately 10^{14} Ohm cm).

ECOBULL M H ACD INERT | ECOBULL T H ACD INERT

These vacuum cleaners are manufactured in accordance with Machinery Directive 2006/42/EC, are designed for use by a single operator, and are intended for:

- to industrial use, such as in manufacturing plants or warehouses;
- vacuuming dry, flammable, deposited, and hazardous dust (dust class According to EN 60335- 2-6);
- Vacuum flammable dust of any dust explosion class;
- Vacuum flammable dust from a zone 22 if the equipment is installed outside potentially explosive areas;
- vacuum titanium dust-conductive dust-aluminum dust-condensation and metal powders from additive manufacturing (3D printing).

The device is not suitable for:

- Vacuum ignition sources and dust with a glow temperature $\leq 190\text{ }^{\circ}\text{C}$;
- Intake of explosive substances or equivalent, explosive vapor-air mixtures;
- Suction of mixtures of flammable fluids and flammable dusts;
- Suction of incandescent or hot particles;
- aspiration of toxic substances;
- Be connected to a machine that generates dust.

WARNING

If combustible dusts and/or flammable gases are present in the workplace, it is the employer's responsibility to classify the area and choose a Category machine (according to definition given in Directive 2014/34/EU).

Any other use is considered **NON-COMPLIANT** with the intended use.

ECOBULL M ATEX SP 3D | ECOBULL T ATEX SP 3D | ECOBULL PLUS ATEX SP 3D

These vacuum cleaners are built according to Directive 2014/34/EU, are designed to be used by a single operator, and are intended:

- to industrial use, such as in manufacturing plants or warehouses;
- To indoor and indoor use;



- To the extraction of combustible dust and/or dry particles in atmospheres classified as **Zone 22**;
- aspirated particles must have the following limitations:
Minimum ignition energy (MIE) of the powder > 3 mJ.

WARNING

It is the responsibility of the Employer to make the zone classification and choose a Category machine (as defined in Directive 2014/34/EU)

Any other use is considered **NON-COMPLIANT** with the intended use.

ECOBULL XM M DEX 1/3D | ECOBULL XM T DEX 1/3D | ECOBULL M DEX 1/3D | ECOBULL T DEX 1/3D | ECOBULL PLUS DEX 1/3D

These vacuum cleaners are built according to Directive 2014/34/EU, are designed to be used by a single operator, and are intended:

- to industrial use, such as in manufacturing plants or warehouses;
- To indoor and indoor use;
- To the extraction of combustible dust and/or dry particles in atmospheres classified as **Zone 22**;
- aspirated particles must have the following limitations:
Minimum ignition energy (MIE) of the powder > 3 mJ.

WARNING

It is the responsibility of the Employer to make the zone classification and choose a Category machine (as defined in Directive 2014/34/EU)

Any other use is considered **NON-COMPLIANT** with the intended use.

ECOBULL M DEX 1/3D INERT | ECOBULL T DEX 1/3D INERT

These vacuum cleaners are built according to Directive 2014/34/EU, are designed to be used by a single operator, and are intended:

- to industrial use, such as in manufacturing plants or warehouses;
- To indoor and indoor use;
- To the extraction of combustible dust and/or dry particles in atmospheres classified as **Zone 22**;
- vacuuming titanium powder – conductive powders – aluminum powder – condensation powders and metal powders resulting from additive manufacturing (3D printing);
- aspirated particles must have the following limitations:
Minimum ignition energy (MIE) of the powder > 3 mJ.

WARNING

It is the responsibility of the Employer to make the zone classification and choose a Category machine (as defined in Directive 2014/34/EU)

Any other use is considered **NON-COMPLIANT** with the intended use.

ECOBULL XM M DEX 1/2D | ECOBULL XM T DEX 1/2D | ECOBULL M DEX 1/2D | ECOBULL T DEX 1/2D | ECOBULL PLUS DEX 1/2D

These vacuum cleaners are built according to Directive 2014/34/EU, are designed to be used by a single operator, and are intended:

- to industrial use, such as in manufacturing plants or warehouses;
- To indoor and indoor use;



- To the extraction of combustible dust and/or dry particles in atmospheres classified as **Zone 21** and **Zone 22**;
- aspirated particles must have the following limitations:
Minimum ignition energy (MIE) of the powder > 3 mJ.

WARNING

It is the responsibility of the Employer to make the zone classification and choose a Category machine (as defined in Directive 2014/34/EU)

Any other use is considered **NON-COMPLIANT** with the intended use.

ECOBULL M DEX 1/2D INERT | ECOBULL T DEX 1/2D INERT

These vacuum cleaners are built according to Directive 2014/34/EU, are designed to be used by a single operator, and are intended:

- to industrial use, such as in manufacturing plants or warehouses;
- To indoor and indoor use;
- to the suction of combustible dust and/or dry particles in atmospheres classified as **Zone 21** and **Zone 22**;
- vacuuming titanium powder – conductive powders – aluminum powder – condensation powders and metal powders resulting from additive manufacturing (3D printing);
- aspirated particles must have the following limitations:
Minimum ignition energy (MIE) of the powder > 3 mJ.

WARNING

It is the responsibility of the Employer to make the zone classification and choose a Category machine (as defined in Directive 2014/34/EU)

Any other use is considered **NON-COMPLIANT** with the intended use.



WARNING

Use only silicone-based inerting oil with high dielectric strength (approximately 10^{14} Ohm cm).

ECOBULL M DEX 3/3G | ECOBULL T DEX 3/3G | ECOBULL PLUS DEX 3/3G

These vacuum cleaners are built according to Directive 2014/34/EU, are designed to be used by a single operator, and are intended:

- to industrial use, such as in manufacturing plants or warehouses;
- To indoor and indoor use;
- To the extraction of combustible dust and/or dry particles in atmospheres classified as **Zone 2**
- aspirated particles must have the following limitations:
Minimum ignition energy (MIE) of the powder > 3 mJ.



WARNING

It is the responsibility of the Employer to make the zone classification and choose a Category machine (as defined in Directive 2014/34/EU)

Any other use is considered **NON-COMPLIANT** with the intended use.

1.7. ATEX MARKING

ECOBULL M ATEX SP 3D | ECOBULL T ATEX SP 3D | ECOBULL PLUS ATEX SP 3D

CE  II 3 G/D Ex h IIIB T160°C Gc/Dc

ECOBULL XM M DEX 1/3D | ECOBULL XM T DEX 1/3D | ECOBULL M DEX 1/3D | ECOBULL T DEX 1/3D | ECOBULL PLUS DEX 1/3D | ECOBULL M DEX 1/3D INERT | ECOBULL T DEX 1/3D INERT

CE  II 1/3 D Ex h IIIC T160°C Da/Dc

ECOBULL XM M DEX 1/2D | ECOBULL XM T DEX 1/2D | ECOBULL M DEX 1/2D | ECOBULL T DEX 1/2D | ECOBULL PLUS DEX 1/2D | ECOBULL M DEX 1/2D INERT | ECOBULL T DEX 1/2D INERT

CE  II 1/2 D Ex h IIIC T160°C Da/Db

ECOBULL M DEX 3/3G | ECOBULL T DEX 3/3G | ECOBULL PLUS DEX 3/3G

CE  II 3/3 G Ex h IIB+H2 T4 Gc/Gc

1.8. ALLOWABLE ENVIRONMENTAL CONDITIONS

To ensure proper operation of the vacuum cleaner, it must be located away from the weather (rain, hail, snow, fog, suspended dust, etc.), with an ambient temperature between 5° and 45°C and humidity not exceeding 70%. The working environment must be clean, sufficiently bright, and free from potentially explosive atmospheres (for non-ATEX models).

1.9. NOISE LEVEL

Phonometric tests carried out on this specific vacuum cleaner model show a sound pressure level of:

Machine	Noise level
ECOBULL M	74 dB(A)
ECOBULL T	72 dB(A)
ECOBULL PLUS	72 dB(A)
ECOBULL M ACD	74 dB(A)
ECOBULL T ACD	72 dB(A)
ECOBULL PLUS ACD	72 dB(A)
ECOBULL M H ACD INERT	72 dB(A)
ECOBULL T H ACD INERT	72 dB(A)
ECOBULL XM M DEX 1/3D	72 dB(A)
ECOBULL XM T DEX 1/3D	72 dB(A)
ECOBULL XM M DEX 1/2D	72 dB(A)
ECOBULL XM T DEX 1/2D	72 dB(A)
ECOBULL M DEX 1/3D	74 dB(A)
ECOBULL T DEX 1/3D	72 dB(A)
ECOBULL PLUS DEX 1/3D	74 dB(A)
ECOBULL M ATEX SP 3D	74 dB(A)
ECOBULL T ATEX SP 3D	72 dB(A)
ECOBULL PLUS ATEX SP 3D	74 dB(A)
ECOBULL M DEX 1/2D	72 dB(A)
ECOBULL T DEX 1/2D	74 dB(A)
ECOBULL PLUS DEX 1/2D	72 dB(A)
ECOBULL M DEX 3/3G	72 dB(A)
ECOBULL T DEX 3/3G	74 dB(A)
ECOBULL PLUS DEX 3/3G	72 dB(A)
ECOBULL M DEX 1/3D INERT	72 dB(A)
ECOBULL T DEX 1/3D INERT	72 dB(A)
ECOBULL M DEX 1/2D INERT	72 dB(A)
ECOBULL T DEX 1/2D INERT	72 dB(A)

WARNING

- For sound pressure levels above 85 dB(A), workers must be protected by appropriate personal protective equipment (PPE), such as approved individual hearing protectors.
- For such conditions, it is necessary to provide workers with training and information on the risks of noise exposure.



1.10. TECHNICAL DATA

	Unit of measurement	ECOBULL M	ECOBULL T	ECOBULL PLUS	ECOBULL M ACD	ECOBULL T ACD	ECOBULL PLUS ACD
Weight	[kg]	85	88	95	85	88	95
Dimensions	[mm]	660 x 800	660 x 800	660 x 800	660 x 800	660 x 800	660 x 800
Height	[mm]	1530	1530	1530	1530	1530	1530
Voltage / Frequency	[V] - [Hz]	230 - 50/60	400 - 50/60	400 - 50/60	230 - 50/60	400 - 50/60	400 - 50/60
Power	[Watt] - [HP]	1800 - 2,4	3000 - 4	4000 - 5,5	1800 - 2,4	3000 - 4	4000 - 5,5
Suction mouth diameter	[Ø mm]	70	70	70	70	70	70
Motors type		Side channel turbine	Side channel turbine	Side channel turbine	Side channel turbine	Side channel turbine	Side channel turbine
Max vacuum / Continuous vacuum	[m Bar]	- / 230	- / 230	- / 270	- / 230	- / 230	- / 270
Max air flow rate	[m ³ /h]	240	340	340	240	340	340
Primary filter		Stellar	Stellar	Stellar	Stellar	Stellar	Stellar
Primary filter surface	[cm ²]	24000	24000	24000	24000	24000	24000
Media		Polyester	Polyester	Polyester	ANTISTATIC Polyester	ANTISTATIC Polyester	ANTISTATIC Polyester
Liquid filter		-	-	-	-	-	-
Spark arrestor filter		-	-	-	-	-	-
Absolute filter		HEPA H14 *	HEPA H14 *	HEPA H14 *	HEPA H14 *	HEPA H14 *	HEPA H14 *
Absolute filter surface	[cm ²]	28000	28000	28000	28000	28000	28000
SP cartridge surface area	[cm ²]	90,000 *	90,000 *	90,000 *	90,000 *	90,000 *	90,000 *
Noisiness	[dB(A)]	74	72	72	74	72	72
Container capacity	[L]	65 / 100 *	65 / 100 *	65 / 100 *	65 / 100 *	65 / 100 *	65 / 100 *
Inerting oil capacity	[L]	-	-	-	-	-	-
Inertizable powder capacity	[L]	-	-	-	-	-	-

* = filter, cartridge, and/or optional component



	Unit of measurement	ECOBULL M H ACD INERT	ECOBULL T H ACD INERT	ECOBULL XM M DEX 1/3D	ECOBULL XM T DEX 1/3D	ECOBULL XM M DEX 1/2D	ECOBULL XM T DEX 1/2D
Weight	[kg]	95	120	57	57	57	57
Dimensions	[mm]	660 x 800	660 x 800	516 x 545	516 x 545	516 x 545	516 x 545
Height	[mm]	1630	1630	1050	1050	1050	1050
Voltage / Frequency	[V] - [Hz]	230 - 50/60	400 - 50/60	230 - 50/60	400 - 50/60	230 - 50/60	400 - 50/60
Power	[Watt] - [HP]	1800 - 2,4	3000 - 4	1800 - 2,4	1800 - 2,4	2200 - 3	2200 - 3
Suction mouth diameter	[Ø mm]	50	50	50	50	50	50
Motors type		Side channel turbine	Side channel turbine	ATEX 3D side channel turbine	ATEX 3D side channel turbine	ATEX 2D side channel turbine	ATEX 2D side channel turbine
Max vacuum / Continuous vacuum	[m Bar]	- / 230	- / 230	- / 180	- / 180	- / 180	- / 180
Max air flow rate	[m³/h]	240	340	240	240	240	240
Primary filter		Conical cartridge	Conical cartridge	Conical cartridge	Conical cartridge	Conical cartridge	Conical cartridge
Primary filter surface	[cm²]	-	-	16,000	16,000	16,000	16,000
Media		ANTISTATIC Polyester	ANTISTATIC Polyester	ANTISTATIC Polyester	ANTISTATIC Polyester	ANTISTATIC Polyester	ANTISTATIC Polyester
Liquid filter		Polypropylene 150µ	Polypropylene 150µ	-	-	-	-
Spark arrestor filter		Wire mesh filter	Wire mesh filter	-	-	-	-
Absolute filter		HEPA H13	HEPA H13	HEPA H14 *	HEPA H14 *	HEPA H14 *	HEPA H14 *
Absolute filter surface	[cm²]	35000	35000	22000	22000	22000	22000
SP cartridge surface area	[cm²]	-	-	-	-	-	-
Noisiness	[dB(A)]	72	72	72	72	72	72
Container capacity	[L]	100 Container for inerting	100 Container for inerting	20	20	20	20
Inerting oil capacity	[L]	11	11	-	-	-	-
Inertizable powder capacity	[L]	10	10	-	-	-	-

* = filter, cartridge, and/or optional component
Inerting oil not supplied with the container



	Unit of measurement	ECOBULL M DEX 1/3D	ECOBULL T DEX 1/3D	ECOBULL PLUS DEX 1/3D	ECOBULL M ATEX SP 3D	ECOBULL T ATEX SP 3D	ECOBULL PLUS ATEX SP 3D
Weight	[kg]	95	95	95	95	95	95
Dimensions	[mm]	660 x 800	660 x 800	660 x 800	660 x 800	660 x 800	660 x 800
Height	[mm]	1630	1630	1630	1630	1630	1630
Voltage / Frequency	[V] - [Hz]	230 - 50/60	400 - 50/60	400 - 50/60	230 - 50/60	400 - 50/60	400 - 50/60
Power	[Watt] - [HP]	1800 - 2,4	3000 - 4	4000 - 5,5	1800 - 2,4	3000 - 4	4000 - 5,5
Suction mouth diameter	[Ø mm]	70	70	70	70	70	70
Motors type		ATEX 3D side channel turbine	ATEX 3D side channel turbine	ATEX 3D side channel turbine	ATEX 3D side channel turbine	ATEX 3D side channel turbine	ATEX 3D side channel turbine
Max vacuum / Continuous vacuum	[m Bar]	- / 180	- / 230	- / 270	- / 180	- / 230	- / 270
Max air flow rate	[m³/h]	240	340	350	240	340	350
Primary filter		Stellar	Stellar	Stellar	3X Cartridges	3X Cartridges	3X Cartridges
Primary filter surface	[cm²]	24000	24000	24000	-	-	-
Media		ANTISTATIC Polyester	ANTISTATIC Polyester	ANTISTATIC Polyester	ANTISTATIC Polyester	ANTISTATIC Polyester	ANTISTATIC Polyester
Liquid filter		-	-	-	-	-	-
Spark arrestor filter		-	-	-	-	-	-
Absolute filter		HEPA H14 *	HEPA H14 *	HEPA H14 *	HEPA H14 *	HEPA H14 *	HEPA H14 *
Absolute filter surface	[cm²]	28000	28000	28000	28000	28000	28000
SP cartridge surface area	[cm²]	-	-	-	90000	90000	90000
Noisiness	[dB(A)]	74	72	74	74	72	74
Container capacity	[L]	65 / 100 *	65 / 100 *	65 / 100 *	65 / 100 *	65 / 100 *	65 / 100 *
Inerting oil capacity	[L]	-	-	-	-	-	-
Inertizable powder capacity	[L]	-	-	-	-	-	-

* = filter, cartridge, and/or optional component



	Unit of measurement	ECOBULL M DEX 1/2D	ECOBULL T DEX 1/2D	ECOBULL PLUS DEX 1/2D	ECOBULL M DEX 3/3G	ECOBULL T DEX 3/3G	ECOBULL PLUS DEX 3/3G
Weight	[kg]	95	95	95	95	95	95
Dimensions	[mm]	660 x 800	660 x 800	660 x 800	660 x 800	660 x 800	660 x 800
Height	[mm]	1630	1630	1630	1630	1630	1630
Voltage / Frequency	[V] - [Hz]	230 - 50/60	400 - 50/60	400 - 50/60	230 - 50/60	400 - 50/60	400 - 50/60
Power	[Watt] - [HP]	1800 - 2,4	3000 - 4	4000 - 5,5	1800 - 2,4	3000 - 4	4000 - 5,5
Suction mouth diameter	[Ø mm]	70	70	70	70	70	70
Motors type		ATEX 2D side channel turbine	ATEX 2D side channel turbine	ATEX 2D side channel turbine	ATEX 3G side channel turbine	ATEX 3G side channel turbine	ATEX 3G side channel turbine
Max vacuum / Continuous vacuum	[m Bar]	- / 180	- / 230	- / 270	- / 180	- / 230	- / 270
Max air flow rate	[m ³ /h]	240	340	350	240	340	350
Primary filter		Stellar	Stellar	Stellar	Stellar	Stellar	Stellar
Primary filter surface	[cm ²]	24000	24000	24000	24000	24000	24000
Media		ANTISTATIC Polyester	ANTISTATIC Polyester	ANTISTATIC Polyester	ANTISTATIC Polyester	ANTISTATIC Polyester	ANTISTATIC Polyester
Liquid filter		-	-	-	-	-	-
Spark arrestor filter		-	-	-	-	-	-
Absolute filter		HEPA H14 *	HEPA H14 *	HEPA H14 *	HEPA H14 *	HEPA H14 *	HEPA H14 *
Absolute filter surface	[cm ²]	28000	28000	28000	28000	28000	28000
SP cartridge surface area	[cm ²]	-	-	-	-	-	-
Noisiness	[dB(A)]	72	74	72	72	74	72
Container capacity	[L]	65 / 100 *	65 / 100 *	65 / 100 *	65 / 100 *	65 / 100 *	65 / 100 *
Inerting oil capacity	[L]	-	-	-	-	-	-
Inertizable powder capacity	[L]	-	-	-	-	-	-

* = filter, cartridge, and/or optional component



	Unit of measurement	ECOBULL M DEX 1/3D INERT	ECOBULL T DEX 1/3D INERT	ECOBULL M DEX 1/2D INERT	ECOBULL T DEX 1/2D INERT
Weight	[kg]	95	95	95	95
Dimensions	[mm]	660 x 800	660 x 800	660 x 800	660 x 800
Height	[mm]	1630	1630	1630	1630
Voltage / Frequency	[V] - [Hz]	230 - 50/60	400 - 50/60	230 - 50/60	400 - 50/60
Power	[Watt] - [HP]	1800 - 2,4	3000 - 4	2200 - 3	3000 - 4
Suction mouth diameter	[Ø mm]	50	50	50	50
Motors type		ATEX 3D side channel turbine	ATEX 3D side channel turbine	ATEX 2D side channel turbine	ATEX 2D side channel turbine
Max vacuum / Continuous vacuum	[m Bar]	- / 180	- / 230	- / 180	- / 230
Max air flow rate	[m³/h]	240	340	240	340
Primary filter		Conical cartridge	Conical cartridge	Conical cartridge	Conical cartridge
Primary filter surface	[cm²]	-	-	-	-
Media		ANTISTATIC Polyester	ANTISTATIC Polyester	ANTISTATIC Polyester	ANTISTATIC Polyester
Liquid filter		Polypropylene 150µ	Polypropylene 150µ	Polypropylene 150µ	Polypropylene 150µ
Spark arrestor filter		Wire mesh filter	Wire mesh filter	Wire mesh filter	Wire mesh filter
Absolute filter		HEPA H13	HEPA H13	HEPA H13	HEPA H13
Absolute filter surface	[cm²]	35000	35000	35000	35000
SP cartridge surface area	[cm²]	-	-	-	-
Noisiness	[dB(A)]	72	72	72	72
Container capacity	[L]	100 Container for inerting	100 Container for inerting	100 Container for inerting	100 Container for inerting
Inerting oil capacity	[L]	11	11	11	11
Inertizable powder capacity	[L]	10	10	10	10

* = filter, cartridge, and/or optional component
Inerting oil not supplied with the container



The vacuum cleaner can be equipped with the following filters, distinguished between the supplied and optional filters:

	STELLAR M	STELLAR M ANTISTATIC	STELLAR M TEFLONATED	STELLAR NOMEX	STELLAR M PTFE	STELLARE M ANTISTATIC PTFE	CARTRIDGE CONICAL M ANTISTATIC	CARTRIDGE CONICAL M PTFE	CARTRIDGE CONICA HEPA H13	CARTRIDGE HEPA H14
ECOBULL M	●	○	○	○	○	○	-	-	-	○
ECOBULL T	●	○	○	○	○	○	-	-	-	○
ECOBULL PLUS	●	○	○	○	○	○	-	-	-	○
ECOBULL M ACD	-	-	-	-	-	●	-	-	-	○
ECOBULL T ACD	-	-	-	-	-	●	-	-	-	○
ECOBULL PLUS ACD	-	-	-	-	-	●	-	-	-	○
ECOBULL M H ACD INERT	-	-	-	-	-	-	-	-	●	-
ECOBULL T H ACD INERT	-	-	-	-	-	-	-	-	●	-
ECOBULL XM M DEX 1/3D	-	-	-	-	-	-	●	-	-	○
ECOBULL XM T DEX 1/3D	-	-	-	-	-	-	●	-	-	○
ECOBULL XM M DEX 1/2D	-	-	-	-	-	-	●	-	-	○
ECOBULL XM T DEX 1/2D	-	-	-	-	-	-	●	-	-	○
ECOBULL M DEX 1/3D	-	●	-	-	-	○	-	-	-	○
ECOBULL T DEX 1/3D	-	●	-	-	-	○	-	-	-	○
ECOBULL PLUS DEX 1/3D	-	●	-	-	-	○	-	-	-	○
ECOBULL M ATEX SP 3D	-	-	-	-	-	-	● (SP)	-	-	○
ECOBULL T ATEX SP 3D	-	-	-	-	-	-	● (SP)	-	-	○
ECOBULL PLUS ATEX SP 3D	-	-	-	-	-	-	● (SP)	-	-	○
ECOBULL M DEX 1/2D	-	●	-	-	-	○	-	-	-	○
ECOBULL T DEX 1/2D	-	●	-	-	-	○	-	-	-	○
ECOBULL PLUS DEX 1/2D	-	●	-	-	-	○	-	-	-	○
ECOBULL M DEX 3/3G	-	●	-	-	-	○	-	-	-	○
ECOBULL T DEX 3/3G	-	●	-	-	-	○	-	-	-	○
ECOBULL PLUS DEX 3/3G	-	●	-	-	-	○	-	-	-	○
ECOBULL M DEX 1/3D INERT	-	-	-	-	-	-	-	-	●	-
ECOBULL T DEX 1/3D INERT	-	-	-	-	-	-	-	-	●	-
ECOBULL M DEX 1/2D INERT	-	-	-	-	-	-	-	-	●	-
ECOBULL T DEX 1/2D INERT	-	-	-	-	-	-	-	-	●	-

● = filter supplied with the vacuum cleaner

○ = optional filter

1.11. WARRANTY

DEPURECO guarantees this model of vacuum cleaner for a period of 12 months from the date of purchase, indicated on the fiscal document at the time of delivery of the product. The warranty shall be void if the vacuum cleaner has been repaired by unauthorized third parties or if equipment, accessories or components not supplied or authorized by DEPURECO or for which the serial number is found to have been removed (during the warranty period) are used. DEPURECO agrees to repair or replace free of charge those parts or components that within the warranty period are proven to be defective from manufacture.

Repairs are carried out exclusively at our premises or at the Service Center indicated by us and must be received carriage paid (freight charges to be paid by the user, unless otherwise agreed).

The warranty does not cover the cleaning of working organs.

The purchase tax document must be shown to the authorized technical personnel performing the repair or must accompany the vacuum cleaner in shipment. Defects not clearly attributed to material or manufacture will be investigated exclusively at our office or at our designated Technical Service Center. Should the claim prove to be unjustified, all costs of repair and/or replacement of parts, will be charged to the purchaser.

Excluded from the warranty are: accidental damage due to transportation, carelessness or inadequate handling, improper use, not in accordance with the warnings in this booklet, or arising from phenomena not dependent on normal use/operation of the vacuum cleaner.

DEPURECO is not liable for any personal injury or property damage resulting from improper or incorrect use of the vacuum cleaner.

For any dispute, the Court of Turin (Italy) shall have jurisdiction.



2. SAFETY SECTION

2.1. SAFETY INFORMATION

Pursuant to Legislative Decree 81/08 and subsequent additions and amendments, the Head of the Safety has an obligation to train, inform and educate workers on the hazards involved in vacuum cleaner use so that they are able to protect their own and others' safety.

Failure to observe basic safety regulations or precautions, could result in an accident during the use, maintenance and repair of the vacuum cleaner. An accident can often be avoided by recognizing potential dangerous situations before they occur. Proper training is the basic prerequisite for this.

WARNING

Use only original Depureco spare parts. We disclaim any responsibility for the use of non-original spare parts.

2.2. SAFETY PRESCRIPTIONS

WARNING

The directions below play an important role in completely preserving you from all the hazards you may encounter when operating the vacuum cleaner.

However, they will not be able to be separated from the competence and common sense of those who work, as an overall framework for careful accident prevention.

Additional safety requirements specific to different operations are listed in each section.

Prior to use, operators should receive the necessary training in the use of the machine and information on the substances for which it is to be used, including safe methods for removal and disposal of collected material.

Commissioning - connection to the power grid:

- Before commissioning, make sure the vacuum cleaner has no obvious damage.
- Before connecting the inlet, make sure the air hoses are properly positioned (for vacuum cleaners equipped with counter-current air cleaning system). Carry out the operation in a safe area free of explosive atmospheres.
- Before connecting the vacuum cleaner to the mains, make sure that the voltage indicated on the nameplate matches the mains voltage.
- Plug the power cord into an outlet with properly installed grounding contact/connection. Make sure the vacuum cleaner is turned off.
- Mains cable plugs and connectors must be protected from water splashes.
- Check for proper connection to the power grid.
- Ensure that the grounding clamp is properly connected, to a point for which continuity with the grounding system is guaranteed.
- Use only vacuum cleaners with mains connection cables in perfect condition in order to avoid the danger of electric shock.
- Regularly check for damage and signs of wear, cracking, or aging of the grid connection cable.

During operation, avoid:

- Step on, crush, pull or damage the power connection cable.
- Disconnect the cable from the mains only by pulling the plug (do not pull the cable itself).
- When replacing the power supply cable, replace it with one of the same type as the original one installed.
- The power cord must be replaced by the manufacturer's Service Department or equivalent qualified personnel.



It is absolutely forbidden:

- Use of this vacuum cleaner by persons who are not adults and properly trained.
- Make the electrical connection to a network without an efficient grounding.
- Outdoor use in the presence of atmospheric precipitation.
- The use and storage of the vacuum cleaner outdoors in humid conditions.
- The use of the vacuum cleaner in the absence of the appropriate lock placed on the rotating wheel during vacuuming operations.
- The use of the vacuum cleaner placed on unlevel and non-horizontal surfaces.
- Use in corrosive environments.
- Roll or bend the hose during suction.
- For ATEX versions and models, the use of hoses that are not antistatic in the mass (only surface antistaticity is not allowed).
- The use of original DEPURECO accessories is recommended. Check with an ohmmeter for electrical continuity:
 - between nozzle and end of suction accessories: the resistance detected must be less than 100M Ω (for ATEX versions and models);
 - between container and plug (ground pin) in the case of electric machine, or between container and grounding wire (supplied) in the case of compressed air models: the resistance detected must be: - less than 10 Ω (for models and versions where compressed air supply is provided).
- Use of the machine in unclassified working environments according to the information on the machine's nameplate.
- Vacuum the following materials:
 - burning materials (embers, hot ashes, lit cigarettes, etc.);
 - open flames;
 - combustible gases;
 - Flammable, combustible, aggressive liquids (gasoline, solvents, acids, alkaline solutions, etc.);
 - Explosive and spontaneously igniting dusts/substances and/or mixtures thereof (magnesium powders, etc.).
- Prolonged contact with solvents and inhalation of their vapors.
- Use near open flames or heat sources; then ensure adequate ventilation.
- The use of the exhaust fan in rooms where the suitable air exchange rate is not guaranteed, in the case where exhaust air is recirculated in the said room. To meet the required limit values, the recirculation volume flow rate must not exceed 50% of the volume of fresh air.
- Tamper with or change the limiting valve set by the manufacturer (in models where present).
- Do not use the JetClean cleaning system in the presence of potentially explosive clouds in the atmosphere (for models and versions where this cleaning system is provided).
- Perform maintenance on the industrial vacuum cleaner in ATEX classified areas (for ATEX models and versions).
- Perform maintenance on the vacuum cleaner without first turning off the machine and unplugging the electrical plug from the outlet.
- Keep foreign materials such as debris, oil, tools and other objects inside the container that could damage operation and cause personal injury.
- The use of flammable or toxic solvents such as gasoline, benzene, ether and alcohol for cleaning.
- Use without the filter unit provided by the manufacturer.
- The use of the industrial vacuum cleaner in the absence of safety devices or with such devices inefficient
- The use of the industrial vacuum cleaner with guards and guards not in place.
- Insert hands inside the container positioning guides and between the container and the vacuum cleaner during the operation of Inserting and locking the debris container under the vacuum cleaner itself: movement of the lifting handle can cause fingers to be crushed. Therefore wear gloves when removing the suction head, filter unit or collection container.
- Open the container with the vacuum cleaner running.
- Open the container in the area classified as potentially explosive.
- Continue to keep the vacuum cleaner activated and powered through the mains plug in case of prolonged work breaks after use.
- Add extension lines, plug-in connection devices and adapters.
- Get on the vacuum cleaner.



- Move the vacuum cleaner while it is running.
- Wear loose or dangling garments such as ties, scarves, torn clothing that can snag or be sucked up by the vacuum cleaner.
- Touch electrical wires, switches, buttons, etc. with wet hands.
- Touching, while using the industrial vacuum cleaner, some components (motor terminal board, motor body in particular) that may reach high temperatures.

WARNING

This vacuum cleaner may contain dust that is harmful to health.

Emptying and maintenance procedures, including the removal of containers of dust collection should be carried out only by trained personnel wearing appropriate protective equipment.

This manual should always be available for reference on the planned operating cycle and whenever there is any doubt.

If it is lost or damaged, a replacement copy should be requested from DEPURECO.

ECOBULL M ACD | ECOBULL T ACD | ECOBULL PLUS ACD

- Observe the safety regulations applicable to the materials to be processed.
- Do not operate the device without the complete filter system.
- Simultaneous collection of several combustible dusts in the collection container may lead to fire or explosion.

ECOBULL M H ACD INERT | ECOBULL T H ACD INERT | ECOBULL M DEX 1/3D INERT | ECOBULL T DEX 1/3D INERT | ECOBULL M DEX 1/2D INERT | ECOBULL T DEX 1/2D INERT

- Observe the safety regulations applicable to the materials to be processed.
- Do not operate the device without the complete filter system.
- Simultaneous collection of several combustible dusts in the collection container may lead to fire or explosion.
- Before turning on the aspirator, check that the inerting liquid has reached the required level (the liquid must be visible in the level indicator on the container).
- Near the level indicator, there is a label indicating the exact level of inerting liquid allowed inside the container.
- If the level of the inerting liquid is lower than required,
Proceed immediately with refilling as follows:
 - Unhook the container (see Section 4.5);
 - Remove the double sponge filter kit, the nylon filter, and the mesh filter
 - Pour the inerting oil into the container to the correct level;
 - Reassemble the components following the previous steps in reverse order.

WARNING

- Use only silicone-based inerting oil with high dielectric strength (approximately 10^{14} Ohm cm).

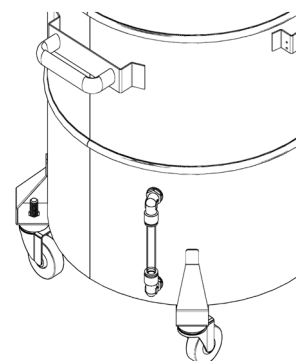



2.3. ATEX SAFETY INSTRUCTIONS



- Hexagon Ex - ATEX Directive 2014/34/EU. In this manual, the Ex hexagon is placed alongside the main safety instructions on explosion risk.
- All personnel involved in installation, operation and maintenance of the equipment and its components should receive technical training corresponding to the tasks to be performed, particularly for working in areas with a potentially explosive atmosphere. Any changes made to this equipment may invalidate its safety requirements. Always follow the manufacturer's instructions.
- ZONE 20: area in which an explosive atmosphere in the form of a combustible dust cloud in the air is present permanently or for long periods or frequently. The use of the device is prohibited in areas classified as ZONE 0, 1, or 2 due to the presence of gas.
- ZONE 21: area in which, during normal activities, an explosive atmosphere in the form of a combustible dust cloud in the air is likely to occur occasionally. The use of the device is prohibited in areas classified as ZONE 0, 1, or 2 due to the presence of gas.
- ZONE 22: area in which, during normal activities, the formation of an explosive atmosphere in the form of a combustible dust cloud is unlikely and, if it does occur, will only be of short duration. The use of the device is prohibited in areas classified as ZONE 0, 1, or 2 due to the presence of gas.
- ZONE 2: area in which, during normal activities, an explosive atmosphere is not likely to occur due to the presence of flammable gases or vapors and, if it does occur, it is only for a short period of time. The use of the device is prohibited in areas classified as ZONE 0 or 1 for the presence of gas and ZONE 20, 21, or 22 for the presence of dust.
- Combustible powders with the following characteristics can be processed:

Self flammability in MIT cloud	°C	>215
Self-flammability in LIT layer	°C	>215
Minimum Trigger Energy (MIE) at all operating temperatures	°C	≥3

- It turns out that it is prohibited to use the device with hybrid mixtures, explosives and class St2 and St3 chemically unstable dusts.
- Depureco ATEX vacuum cleaners with II 1/3 D Ex h IIIC T160°C Da/Dc marking
- II 1/3 D Ex htc IIIC T140°C Da/Dc are certified to contain a ZONE 20 inside and can be used in ZONE 22.
- Depureco ATEX vacuum cleaners with II 1/2 D Ex h IIIC T160°C Da/Db marking are certified to contain a ZONE 20 inside and can be used in ZONE 21 and ZONE 22.
- Depureco ATEX vacuum cleaners with II 3/3 G Ex h IIB+H2 T4 Gc/Gc marking are certified to contain a ZONE 2 inside and can be used in ZONE 2.
- It is the responsibility of the user to ensure that the equipment is used in a manner consistent with its intended use, particularly that it is used in ZONES classified as compatible with those for which the equipment is declared suitable by the manufacturer.
- The 'device is designed to work under standard environmental conditions:
 - Temperature $-15^{\circ}\text{C} \leq T_{\text{amb}} \leq +40^{\circ}\text{C}$.
 - Atmospheric pressure $+0.8/1.1$ bar.The treated product should have a temperature not exceeding 40°C .
- Any electrical or mechanical components to be installed on the equipment must be certified of a category suitable for use:
 - 3D category (ZONE 22).
 - 2D category (ZONE 21).
 - 1D category (ZONE 20).
 - Category 3G (ZONE 2).
- For maintenance or cleaning operations, the user should ensure that the equipment used (vacuum cleaners,



portable lamps, etc.) is of a category suitable for the environment:

- 3D category (ZONE 22).
- 2D category (ZONE 21).
- 1D category (ZONE 20).
- Category 3G (ZONE 2).
- A periodic check of the equipotentiality condition, especially after maintenance operations, between the different metal parts of the equipment, especially the moving parts and filter cages, must be carried out.
- Strictly use antistatic/dissipative components that ensure electrical continuity.
- Before installation and start-up, provide visual inspection for possible transport damage. Instruments used for installation must comply with EN 1127-1 in relation to the area of use. As a preliminary operation carry out grounding and verification of its proper operation. Grounding is provided with visual indication by symbol in European Standard. In Start-up phases carry out the following checks:
 - Verify the proper grounding of the equipment and the condition of equipotentiality between the various parts of the equipment, especially the moving parts;
 - Carry out blank test with acoustic verification (abnormal noise): in case of problems stop the equipment and check the assembly of moving parts;
 - electrical wiring must be carried out by qualified personnel and according to the wiring diagram.
- Adequate training of the operator who performs installation, start-up and normal operation maneuvers of the equipment must be done during the testing and delivery of the equipment.
- The user must ensure that the plant within which the equipment will be installed has been adequately secured, from an explosion risk point of view, before it is started up, and also that the "Explosion Protection Document" has been prepared as required by the ATEX Directive 2014/34/EU.
- THE INTRODUCTION (ASPIRATION) OF SOURCES OF INJECTION FROM OUTSIDE, including those due to self-ignition of dust or by embers combustion, IS PROHIBITED.
- In the case of extraction of dusts that may give rise to self-ignition phenomena, the collection bin must be emptied immediately after each activity. This precaution should also be taken in the case of aspiration of dust of different types whose mixture may give rise to exothermic reactions.
- A periodic check of the equipotentiality condition, especially after maintenance operations, between the different metal parts of the equipment, especially the moving parts and the handle baskets, must be carried out.
- Installation, assembly and disassembly operations must be carried out on machinery that is switched off and in the absence of a potentially explosive atmosphere.
- The installer must check that the process specifications correspond to the equipment characteristics on the nameplate (e.g., with reference to the maximum surface temperature). In the case of material with incompatible product characteristics, use of the equipment is prohibited.
- Manuals for the ATEX components mounted on the equipment are provided in the appendix: the user must observe all safety instructions regarding the use of these components.
- Cleaning of equipment to prevent the formation of combustible dust layers must be carried out by the user. Do not use compressed air for cleaning from dust layers, but appropriate vacuum systems suitable for handling potentially explosive dust (ATEX-certified vacuum cleaners).
- A specially trained operator must be present at all times during the operation of the equipment and must take immediate action by stopping the equipment using the emergency button in case of malfunctions, e.g., abnormal noise (rupture of components), clogging of the inlet and vent piping, rupture of the filter sleeves, suction of foreign bodies presence or sources of ignition.
- When installing and maintaining electrical parts (e.g., cables, cable glands and terminals) always follow the instructions in EN 60079-14. When opening junction boxes (for inspections), check that the gaskets are correctly present when closing them again.
- The plug is not ATEX-compliant (or is not supplied): the user must connect the plug to a socket located in a SAFE PLACE, or must install an ATEX plug.
- Hoses, suction nozzles and filter sleeves are of the antistatic type declared by their respective manufacturers. It is forbidden to use other types of components.
- Protection against atmospheric discharge must be present in the establishment where the equipment is used.
- No ignition sources should be present in the immediate vicinity of the device, for example:
 - flames;
 - embers;
 - hot surfaces;



- sparks (e.g., caused by metal cutting);
- Stray currents and cathodic protection systems;
- Electrical or mechanical equipment that is not ATEX certified;
- Electrostatic charges carried by operators or mobile equipment;
- Radio frequency (RF) and electromagnetic waves (from 10^4Hz at $3 \times 10^{11}\text{Hz}$);
- electromagnetic waves (from $3 \times 10^{11}\text{Hz}$ at $3 \times 10^{15}\text{Hz}$);
- ionizing radiation;
- ultrasound.



2.4. SAFETY PLATES AND SYMBOLS

Labels with safety symbols and/or messages are attached to the vacuum cleaner and packaging. At these pages their exact location and nature of the hazard is indicated.

WARNING

The nameplates and symbols below are indicative and may not be applicable to the models in the vacuum cleaner series described. The presence of each symbol will vary according to the specifications of the series and/or individual model.

WARNING

Ensure that all safety messages are legible. The user is required to immediately replace any safety plates that become illegible due to wear and tear or damage.

Clean them using a cloth, soap and water. Do not use solvents, naphtha or gasoline. Replace damaged plates by requesting them from DEPURECO.

If a nameplate is on a part that is being replaced, make sure a new nameplate is attached to the new part.



This sticker indicates that the device can vacuum dust up to class M.



This sticker indicates that the device can vacuum dust up to class H.



This sticker indicates the manual filter cleaning system.



This sticker warns of the danger of crushing limbs.

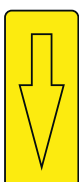
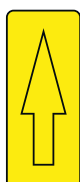

This sticker indicates the need to align the vacuum cleaner components for proper operation.



This sticker indicates that the vacuum cleaner is grounded.



This sticker indicates the supply voltage of the vacuum cleaner.



This sticker indicates the supply voltage of the vacuum cleaner.



This sticker indicates the maximum liquid level inside the container (for models and versions where applicable).



Hexagon Ex - ATEX Directive 2014/34/EU
This sticker indicates that the vacuum cleaner is certified for use in hazardous areas (for dedicated models and versions).



This sticker indicates that the device can vacuum combustible dust in areas not classified as ATEX (for dedicated models and versions).



This sticker indicates that the appliance can vacuum up dust.



This sticker indicates that the appliance can suck up liquids.



This sticker indicates safety requirements.

WARNING

Read the operation and maintenance manual carefully before using the vacuum cleaner or performing maintenance work.

It is strictly forbidden to remove the safety labels on the vacuum cleaner and/or its components and packaging.

DEPURECO accepts no responsibility for the safety of the vacuum cleaner if this prohibition is not observed.

2.5. RESIDUAL RISKS

DEPURECO recommends strict adherence to the instructions, procedures and recommendations in this manual and to current safety regulations. In addition, DEPURECO recommends the use of the prescribed protective equipment, either integrated into the vacuum cleaner or individual.

In this view, the residual hazards analyzed that are present on the vacuum cleaner and/or its components may be:

Electrical hazards in maintenance due to the need to work under voltage

Pursuant to Legislative Decree 81/08-Articles 80 to 87-it is forbidden to work under voltage, except for the exceptions stipulated in that decree.

Risk of misuse in the presence of liquid, deflagrating and flammable substances

The vacuum cleaner should not be used in an environment containing liquid substances or in the form of liquids that can vaporize at room temperature, flammable dusts, gases.

Risks of operating in a humid environment

Comply with the limits given in this manual in Section 1.8 "Allowable Environmental Conditions."

Risk of misinterpretation of safety pictograms

With reference to the analysis of risks and their identification, DEPURECO has installed hazard labels from the regulations on graphic symbols on the vacuum cleaner.

The user is required to immediately replace safety plates that become illegible due to wear and tear or damage.



2.6. DIRECTIVES AND STANDARDS APPLIED

The following guidelines apply to the vacuum cleaner described in this manual:

- 2006/42/EC - Machinery Directive.
- 2014/30/EU - Electromagnetic compatibility directive.
- 2011/65/EU - ROHS - Directive on the restriction of the use of certain hazardous substances in electrical and electronic equipment.
- 2014/35/EU - Low Voltage Directive.
- 2014/34/EU - ATEX Directive (for ATEX models and versions).

The following standards or regulatory documents apply to the vacuum cleaner described in this manual:

- UNI EN 1127-1:2019 (for ATEX models and versions).
- UNI EN ISO 80079-36:2016 (for ATEX models and versions).
- UNI EN ISO 80079-37:2016 (for ATEX models and versions).
- EN 60079-0:2018 (for ATEX models and versions).
- UNI EN 17348:200 (for ATEX models and versions).
- EN 60335-1 (for ACD models and versions).
- EN IEC 61000-3-2:2019 (for ACD models and versions).
- EN IEC 63000:2018 (for ACD models and versions).
- IEC 60335-2-69 (for ACD models and versions).
- EN 55014-2:2015 (for ACD models and versions).

Regulatory references, including mandatory requirements, are managed in the Quality Management System and stored at DEPURECO



3. HANDLING, UNPACKING AND INSTALLATION SECTION

3.1. HANDLING

The instructions that follow also indicate the steps to be taken in case the vacuum cleaner should be newlyAnd packed or unpacked for later transport.

Packaging size:

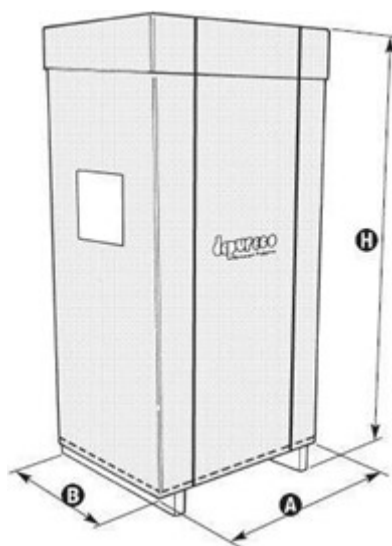

	MU.	A	B	H
ECOBULL M ECOBULL T ECOBULL PLUS ECOBULL M ACD ECOBULL T ACD ECOBULL PLUS ACD ECOBULL M H ACD INERT ECOBULL T H ACD INERT	[cm]	100	75	190
ECOBULL XM M DEX 1/3D ECOBULL XM T DEX 1/3D ECOBULL XM M DEX 1/2D ECOBULL XM T DEX 1/2D	[cm]	80	60	170
ECOBULL M ATEX SP 3D ECOBULL T ATEX SP 3D ECOBULL PLUS ATEX SP 3D	[cm]	100	75	180
ECOBULL M DEX 1/3D ECOBULL T DEX 1/3D ECOBULL PLUS DEX 1/3D ECOBULL M DEX 1/3D INERT ECOBULL T DEX 1/3D INERT ECOBULL M DEX 1/2D ECOBULL T DEX 1/2D ECOBULL PLUS DEX 1/2D ECOBULL M DEX 1/2D INERT ECOBULL T DEX 1/2D INERT	[cm]	100	75	190
ECOBULL M DEX 3/3G ECOBULL T DEX 3/3G ECOBULL PLUS DEX 3/3G	[cm]	100	75	190

Lifting and subsequent handling of the vacuum cleaner should be done only by a forklift of appropriate capacity for the weight.

When moving with the forklift, lift the load 200 mm off the ground and swing backward.

When lifting loads, take into account the height of the environment in which you are working.

Before starting the movement make sure the passage area is clear and that there are no moving objects on the package. For lifting and handling, apply current accident prevention laws and normal forklift driving instructions.

Move the device only at walking pace and, on sloping paths, in twos if necessary.



3.2. UNPACKING

To perform unpacking of the machine:

- Cut the fixing tapes.

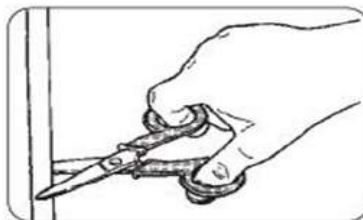

- Remove the retainers with the help of a hammer and screwdriver.

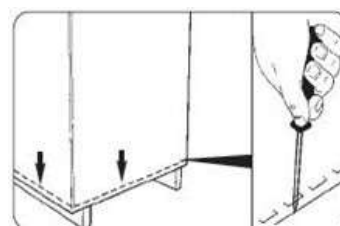

- Unwrap the cardboard packaging.



- Remove all fasteners provided by the manufacturer at packing stage using appropriate tools.

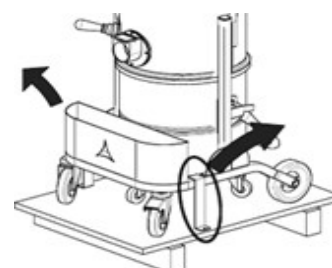

Remove the machine from the support platform by helping yourself with a ramp of suitable capacity and leading the vacuum from the handle.

Conduct these operations on flat, horizontal surfaces. The load-bearing capacity of the support surface must be adequate for the weight of the machine.

Provide ample space around the plant in order to operate with freedom of movement and to allow easy operations by operators in anticipation of future maintenance work.

WARNING

Depureco is not liable for any damage caused to the machine during lifting if the proper equipment is not used.

WARNING

For possible subsequent transport, the vacuum cleaner should be anchored to the support platform by means of a locking system similar to that described above.

WARNING

Dispose of packaging materials in accordance with current legislation.



3.3. INSTALLATION

WARNING!

The following must be complied with before installing the vacuum cleaner in Section 2.2 "Safety requirements."

WARNING!

Before installing the vacuum cleaner, it is necessary to make a careful prior visual inspection in order to detect any damage incurred during transportation.

If one or more components are found to be damaged, it is essential not to proceed further with the installation and to report the anomaly found to Depureco, agreeing with it on the action to be taken. The machine arrives with the planned filter unit already installed.

- Insert the flexible hose with the terminal into the appropriate suction inlet (Part 4, Paragraph 1.2).
- Insert the desired accessory for the suction type from the opposite side of the hose.

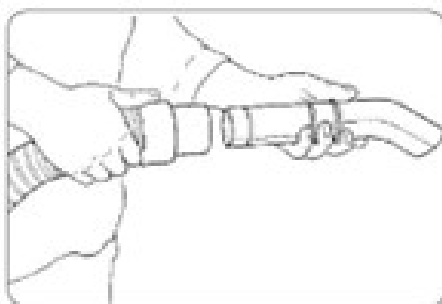

Note: The hose with its terminals and suction accessories are not included in the STANDARD equipment. Contact your dealer (or DEPURECO) for information regarding the different types of OPTIONAL accessories that can be used for this specific vacuum cleaner model.

WARNING

The following operation should be carried out by an electrical technician.

Verify that the electrical supply line matches the voltage and frequency indicated on the vacuum cleaner nameplate and that it is efficiently grounded.

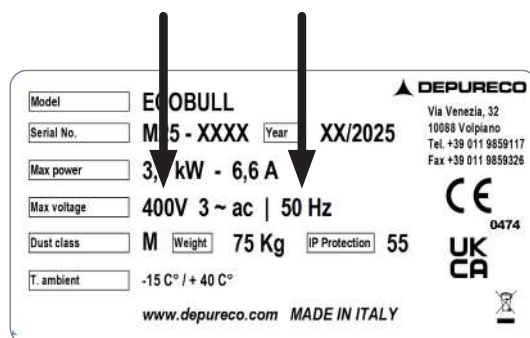

- Finally, insert the plug (standard equipment) into the power outlet.



WARNING

The power outlet to power the vacuum cleaner must be protected by a CE-compliant mains disconnect switch.

WARNING

Do not insert the plug into the outlet with wet hands. The use of extension cords is not allowed.

Before attaching the vacuum cleaner to the power outlet, make sure:

- The power cord is intact and in perfect condition.
- The voltage of the supply line corresponds to that marked on the nameplate data label of the vacuum cleaner.
- The power plug is properly inserted into the power outlet.
- The hose is properly inserted and locked into the suction nozzle.
- The debris collection container must be present and locked onto the vacuum cleaner.
- No dust escapes when replacing accessories.



4. OPERATION SECTION

4.1. COMMAND DESCRIPTION

WARNING

- Before using the vacuum cleaner, it is necessary to comply with the provisions of Paragraph 2.2 "Safety requirements."
- Only authorized personnel who have read these operating and maintenance instructions are allowed to use the vacuum cleaner. The user of the equipment and the maintenance technician who carry out permissible work on the vacuum cleaner must receive appropriate education, information and training, as required by current labor safety laws, and use for the various operations, the prescribed personal protective equipment (PPE), such as safety footwear, gloves, goggles, mask, etc. The user must observe the current regulations for sucked materials and their disposal.
- Before a new work cycle, the personnel in charge must verify that the normal safe operating conditions of the vacuum cleaner and, in particular, the safety devices and protective guards involved in the operation are ensured.
- In case of prolonged work breaks and after use is over, turn off the appliance from the appliance switch and unplug the mains plug.

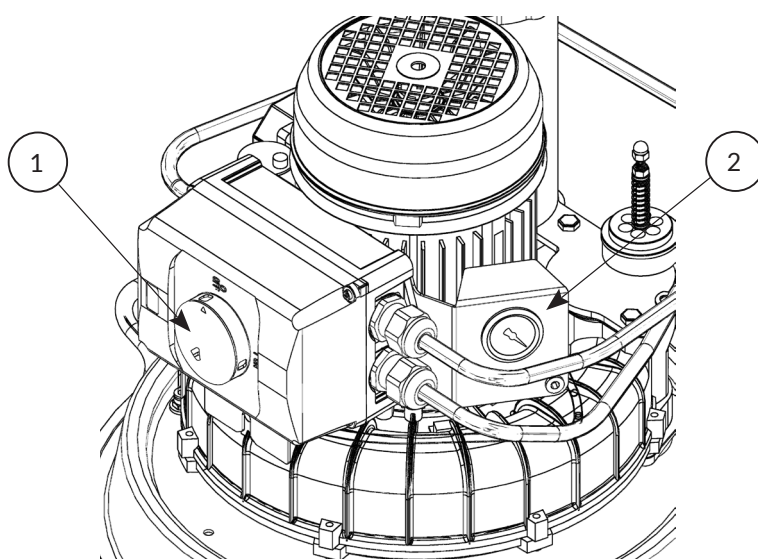

General switch 1 **ON-OFF**

2. vacuum meter **FILTER CLOGGING** (in models where applicable)



4.2. DUTY CYCLE

Before starting suction, it is necessary to comply with the provisions of Paragraph 2.2 "Safety requirements." In particular:

- Make sure the power cord is not damaged and is in perfect condition.
- Before plugging in the power outlet, make sure that the voltage of the power line matches that indicated on the nameplate data label of the appliance.
- Make sure the power plug is properly inserted into the power outlet.
- Ensure that the suction arm or hose is properly inserted and locked into the suction nozzle.
- Ensure that the debris collection container (if any) is properly positioned and locked under the vacuum cleaner chamber.



ATTENTION!

When handling the vacuum cleaner, use the appropriate handles (Part.9 Section 1.2).



WARNING

Do not move the vacuum cleaner while it is in operation.

To start suction, proceed as follows:

- Lock the vacuum cleaner by means of the lever on the turning wheel, as shown in the figure.

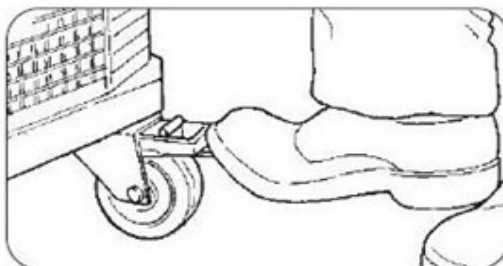

- Grip the end of the hose with the chosen suction attachment or place the end of the suction arm at the suction point.
- Rotate the disconnecter from **O** a **I** to start suction (Part 1, Section 4.1).
- Check that the direction of fan rotation is as indicated by the arrow in the figure.

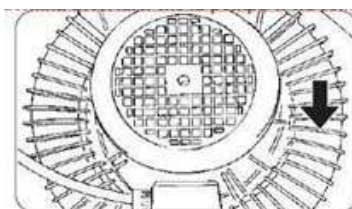



- If the direction of rotation of the motor is incorrect, simply insert a screwdriver into the notch inside the power plug and reverse two poles with a 180° rotation (for versions and models where provided).

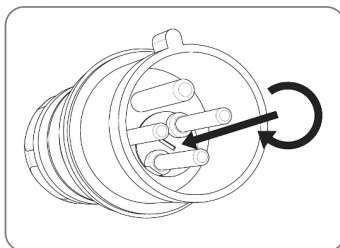

- Turn the switch from I to O to stop suction (Part 1, Paragraph 4.1).

WARNING

Before turning on the vacuum cleaner again, make sure the pump has stopped completely.

WARNING

Avoid stepping on, crushing, pulling or damaging the mains connection cable during operation. Avoid disconnecting the cable from the mains only by pulling the plug (do not pull the cable itself). When replacing the mains cable, replace it only with one of the same type as the original one installed. Replacement must be done by the manufacturer or equivalent qualified personnel.

Those responsible for plant safety must ensure that:

- Any improper use or maneuvering be avoided.
- Safety devices are not removed or tampered with.
- Regular maintenance work is carried out.
- Machine parts (attachments, drilling, etc.) are not modified for any reason to fit additional devices.
- Only original Depureco spare parts should be used.
- Be prevented from rolling or bending the hose during the suction operation.

WARNING

If dust is escaping from the vacuum cleaner head, the filter may have broken. In this case, the vacuum cleaner should be stopped immediately.



4.3. AIR SPEED CONTROL

A vacuum gauge (Part 2, Paragraph 4.1) is mounted on the front of the appliance (on models where provided) to indicate the degree of vacuum inside the extractor. As the vacuum increases, there is a proportional reduction in suction power.

If the vacuum reaches 140 mbar, immediate action should be taken.

- Check the hose and/or suction accessory for clogging and eliminate the cause of clogging.
- Perform a filter cleaning cycle (Section 4.4).
- Stop work and replace filters.



WARNING

Do not use the vacuum cleaner with a clogged filter.

4.4. FILTER CLEANING CYCLE

It is advisable to perform a filter cleaning cycle every 20 minutes of use or if you experience a drop in performance.

ECOBULL M | ECOBULL T | ECOBULL PLUS | ECOBULL M ACD | ECOBULL T ACD | ECOBULL PLUS ACD | ECOBULL M DEX 1/3D | ECOBULL T DEX 1/3D | ECOBULL PLUS DEX 1/3D | ECOBULL M DEX 1/2D | ECOBULL T DEX 1/2D | ECOBULL PLUS DEX 1/2D | ECOBULL M DEX 3/3G | ECOBULL T DEX 3/3G | ECOBULL PLUS DEX 3/3G

To perform a filter cleaning cycle:

- Turn off the machine.
- Wait for the impellers of the motors to come to a complete stop.
- Lift and then lower the lever vigorously (Part 8, Paragraph 1.2) to shake the internal filter.

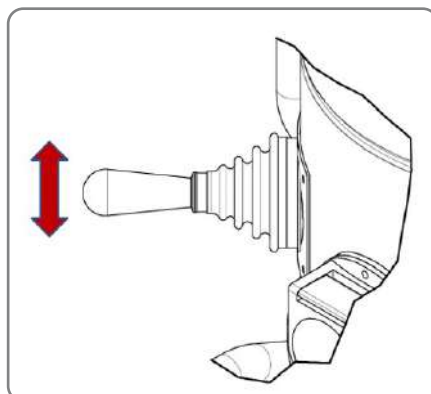



ECOBULL XM M DEX 1/3D | ECOBULL XM T DEX 1/3D | ECOBULL XM M DEX 1/2D | ECOBULL XM T DEX 1/2D

The system works due to the pressure difference between the atmosphere inside and outside the vacuum cleaner causing the dust to detach from the filter fabric of the cartridge, without the need to turn off the vacuum cleaner.

- With the vacuum cleaner on, raise the damper located on the suction nozzle.

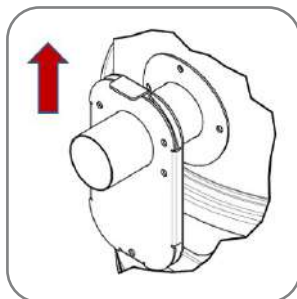

- Quickly open and release the plate and repeat the operation at least three times.

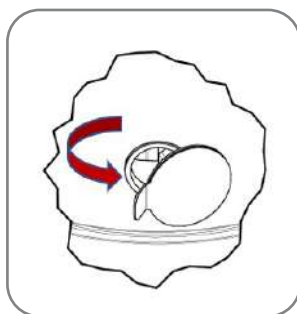

- Lower the damper and resume normal use.

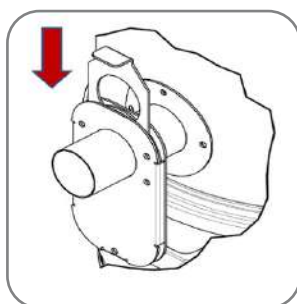



ECOBULL M ATEX SP 3D | ECOBULL T ATEX SP 3D | ECOBULL PLUS ATEX SP 3D

Cleaning is done automatically and continuously while the filter is in use.

For information on the use and maintenance of the PN 2-12 cyclic sequencer shown, refer to the dedicated manual.



CLEANING OPTION SP - CARTRIDGES IN AIR CONTROCORRENT

ECOBULL M | ECOBULL T | ECOBULL PLUS | ECOBULL M ACD | ECOBULL T ACD | ECOBULL PLUS ACD

Cleaning is done automatically and continuously while the filter is in use.

For information on the use and maintenance of the PN 2-12 cyclic sequencer shown, refer to the dedicated manual.



ALL MODELS

If the vacuum cleaner does not work properly after filter cleaning, the main filter may need to be replaced (see dedicated chapter). If the vacuum is not significantly reduced by replacing the filter, it means that another problem is present (see chapter "If something is not working").

WARNING

Do not use the vacuum cleaner with a clogged filter.



⚠ WARNING

 **WARNING**

⚠ WARNING

**ECOBULL M | ECOBULL T | ECOBULL PLUS | ECOBULL M ACD | ECOBULL T ACD | ECO-
BULL PLUS ACD | ECOBULL M DEX 1/3D | ECOBULL PLUS DEX 1/3D | ECOBULL
PLUS ATEX SP 3D | ECOBULL PLUS ATEX SP 3D | ECOBULL PLUS ATEX SP 3D | ECO-
BULL PLUS ATEX SP 3D | ECOBULL PLUS ATEX SP 3D | ECOBULL PLUS ATEX SP 3D
| ECOBULL PLUS ATEX SP 3D | ECOBULL PLUS ATEX SP 3D | ECOBULL PLUS ATEX
SP 3D3D | ECOBULL T DEX 1/3D | ECOBULL PLUS DEX 1/3D | ECOBULL M ATEX SP
3D | ECOBULL T ATEX SP 3D | ECOBULL PLUS ATEX SP 3D | ECOBULL M DEX 1/2D |
ECOBULL T DEX 1/2D | ECOBULL PLUS DEX 1/2D | ECOBULL M DEX 3/3G |
ECOBULL T DEX 3/3G | ECOBULL PLUS DEX 3/3G**

-

-



- Empty the container into the receptacle intended for waste disposal in accordance with the laws of the country of use.



- In case of using a plastic bag for debris collection, after removing the container, tie the bag, pull it out and insert a new bag.



WARNING

If the container weighs more than 50 pounds, you need to get help from another person.

WARNING

Waste disposal must be in accordance with the laws in force in the country where the vacuum cleaner is used - for Italy Legislative Decree 152/2006 as amended.

WARNING

In the case of dust extraction that may give rise to self-ignition phenomena, the collection bin must be emptied immediately after each activity.

This precaution should also be taken in the case of aspiration of dust of different types whose mixture may give rise to exothermic reactions.



**ECOBULL M H ACD INERT | ECOBULL T H ACD INERT | ECOBULL M DEX 1/3D INERT |
ECOBULL T DEX 1/3D INERT | ECOBULL M DEX 1/2D INERT | ECOBULL T DEX 1/2D
INERT**

Empty the container of the inert liquid, following the instructions here:

- Unlock the container by raising the appropriate lever (Part 6, Paragraph 1.2).

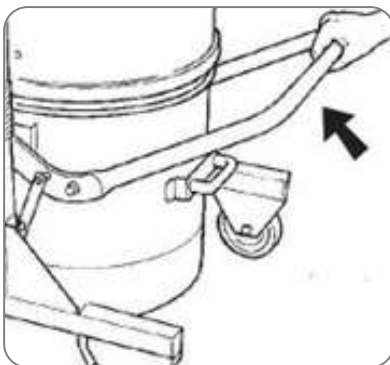

- Remove the container (Part 5, Paragraph 1.2) from under the chamber and take it to the site designated for the collection/disposal of inert liquid.



- Turn the lever on the ball valve 90° and empty the container.

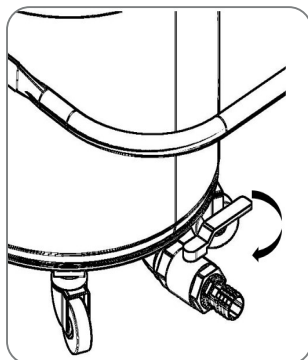



- When the collection container is completely emptied, return the lever to the initial position.
- Clean the appliance inside and out by vacuuming and with a damp cloth. When vacuuming the appliance, use a vacuum cleaner with an equal or better rating.



WARNING

For proper disposal of wastewater, follow local regulations.

ECOBULL XM M DEX 1/3D | ECOBULL XM T DEX 1/3D | ECOBULL XM M DEX 1/2D | ECOBULL XM T DEX 1/2D

- Unlock the container by releasing the appropriate locking hooks (Part 7, Paragraph 1.2).
- Remove the container (Part 5, Section 1.2) from under the chamber.
- Empty the container into the receptacle intended for waste disposal in accordance with the laws of the country of use.



If a plastic bag is used for debris collection, proceed as follows for replacement:

- After removing the container, tie the bag, pull it out, and insert a new bag.



WARNING

If the container weighs more than 50 pounds, you need to get help from another person.



WARNING

Waste disposal must be in accordance with the laws in force in the country where the vacuum cleaner is used - for Italy Legislative Decree 152/2006 as amended.



WARNING

In the case of dust extraction that may give rise to self-ignition phenomena, the collection bin must be emptied immediately after each activity.

This precaution should also be taken in the case of aspiration of dust of different types whose mixture may give rise to exothermic reactions.



4.6. INSERTING AND LOCKING THE CONTAINER

ECOBULL M | ECOBULL T | ECOBULL PLUS | ECOBULL M ACD | ECOBULL T ACD | ECOBULL PLUS ACD | ECOBULL M H ACD INERT | ECOBULL T H ACD INERT | ECOBULL M DEX 1/3D | ECOBULL T DEX 1/3D | ECOBULL PLUS DEX 1/3D | ECOBULL M ATEX SP 3D | ECOBULL T ATEX SP 3D | ECOBULL PLUS ATEX SP 3D | ECOBULL M DEX 1/2D | ECOBULL T DEX 1/2D | ECOBULL PLUS DEX 1/2D | ECOBULL M DEX 3/3G | ECOBULL T DEX 3/3G | ECOBULL PLUS DEX 3/3G | ECOBULL M DEX 1/3D INERT | ECOBULL T DEX 1/3D INERT | ECOBULL M DEX 1/2D INERT | ECOBULL T DEX 1/2D INERT

- Insert the container under the vacuum cleaner, holding the lever up, until it comes to a complete stop against detentions.



- Check that the pins (A) on both sides of the container are aligned with the slots (B) of the guides.

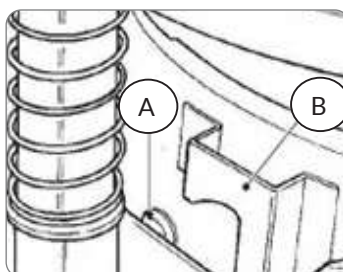

- Lower the container locking lever completely and with both hands.

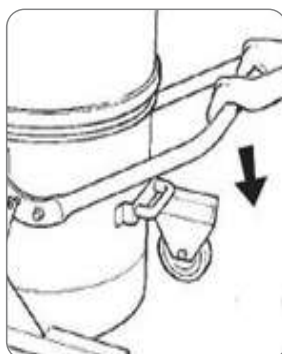

WARNING

Danger of crushing upper limbs!

Never insert your hands between the container and the vacuum cleaner during the clamping operation. Perform the container locking operation by operating the appropriate lever with **BOTH HANDS**.



ECOBULL XM M DEX 1/3D | ECOBULL XM T DEX 1/3D | ECOBULL XM M DEX 1/2D | ECOBULL XM T DEX 1/2D

- Insert the container under the extractor, aligning the closing hooks (C) with the stops (D) on the filter chamber.

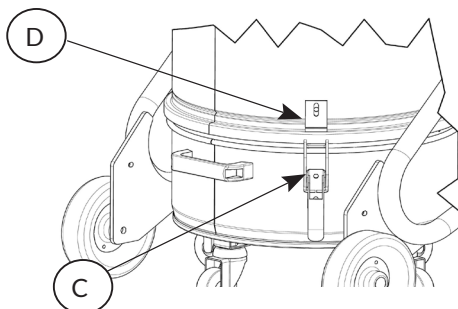

- Raise the container toward the chamber and lock the locking hooks.



WARNING

Danger of crushing upper limbs!

Never insert your hands between the container and the vacuum cleaner during the clamping operation.

4.7. STORAGE - DECOMMISSIONING

Remove the filter and clean it, empty the debris collection container, and store it the vacuum cleaner in a place sheltered from the weather with temperatures between 5° and 45°C, covering it with a nylon cloth so as to prevent dust accumulation.



5. MAINTENANCE SECTION



WARNING

Extraordinary maintenance of the vacuum cleaner should be carried out only by specialized technicians recognized by the DEPURECO dealer.

5.1. INFORMATIONAL NOTES

Maximum vacuum cleaner reliability and minimum maintenance cost are the result of a planned and scrupulously followed maintenance and inspection program throughout the life of the vacuum cleaner. It is important to:

- Strictly adhere to the established maintenance time intervals and cadence the maintenance work according to the specific needs in relation to the production cycle of the vacuum cleaner.
- Always use tools that are in perfect condition and specially made for the task at hand; the use of unsuitable and inefficient equipment can cause serious damage.
- Any other work that may be necessary to eliminate faults or malfunctions must be expressly authorized by the manufacturer.
- For major repairs, it is advisable to contact the authorized dealer whose trained staff, equipped with all the technological experience of the original factory construction, is always on call and able to take timely action.
- Disassembly, cleaning, and maintenance of the vacuum cleaner by the user should be carried out whenever possible without leading to hazards to maintenance personnel and third parties. Suitable precautionary measures include decontamination before disassembly, measures for filtered forced ventilation of the room where the unit is disassembled, cleaning of the maintenance area, and suitable personal protective equipment.
- The manufacturer or qualified person should perform, at least once a quarter (or more frequently depending on the working cycle and conditions of use), an inspection to the filters checking that they are not damaged, also check the proper functioning of the control devices.



WARNING

Following maintenance or repair work, all contaminated items that cannot be satisfactorily cleaned should be placed in waterproof bags and disposed of in accordance with applicable laws.

5.2. GENERAL SAFETY STANDARDS



WARNING

All maintenance, repair, or cleaning must be done with the plug disconnected from the power outlet (and the air disconnected for the CCA system). Appropriate PPE (protective clothing, goggles and/or gloves, etc.) must be worn depending on the work to be performed.

Affix a sign on the vacuum cleaner indicating:

"MACHINE UNDER MAINTENANCE DO NOT START"

Before resuming service, recheck the entire system in accordance with the start-up procedures. Perform a few test cycles after each maintenance operation to check that the machine is working properly. Failure to observe these precautions may result in serious injury to personnel. Maintenance work must be performed by technicians who are skilled and trained in the specific areas, which for this machine are:

- Mechanical maintenance.
- Electrical maintenance.

It is the specific duty of the **Head of Security** Ensure the professionalism and competence of the aforementioned people.

Before starting a maintenance task, the Safety Officer must:



- Have the work area cleared of outsiders.
- Make sure the necessary tools are within reach of the maintainer and are in good condition.
- Ensure that the maintenance worker has the necessary personal protective equipment for the specific operation (gloves, goggles, shoes, mask, etc.).
- Ensure that the maintainer has carefully read the instructions in this manual and is fully familiar with the operation of the vacuum cleaner and its components.
- Check for sufficient lighting and provide 24-volt powered portable lamps if necessary.

Before starting maintenance work, the Maintainer must disconnect all electrical supplies and put the vacuum cleaner in a safety lockout condition and disconnect the connection to compressed air (where applicable).

WARNING

If it is absolutely necessary to operate with the power on, when required by D. Lgs. 81/08, the maintainer must keep a safe distance, have stop buttons within reach, and never put hands in the discharge volume. At the end of the intervention and before resuming service, the maintainer must recheck the functionality of safety devices and the integrity of protections.

Work on motors or other electrical components should be performed only by the specially trained Electrical Maintenance Worker authorized by the Safety Officer.

WARNING

After each maintenance work, the Safety Officer is obliged to ensure the safe condition of the vacuum cleaner and its protective devices.

Before each work shift:

- Check that the power cord and plug are not damaged: replace it immediately if it shows signs of wear and tear, using a cord of the same type (information c/o DEPURECO) - operation the sole responsibility of an electrician.
- Check the integrity of the safety symbols (pictograms) attached to the vacuum cleaner.
- Check that the debris collection container is empty and properly locked under the vacuum cleaner.
- Verify proper filter efficiency by checking the indicator light or vacuum gauge.
- Check the integrity of the suction hose and accessories to be used.

WARNING

The hose, if perforated, decreases the suction power and disperses dust into the air.



5.3. PRIMARY FILTER REPLACEMENT

WARNING

Wear appropriate PPE (dust mask, latex gloves, goggles, etc.).

For the filter replacement primary Operate as follows:

- Turn off the machine.
- Disconnect the vacuum cleaner from the power supply.

ECOBULL M | ECOBULL T | ECOBULL PLUS | ECOBULL M ACD | ECOBULL T ACD | ECOBULL PLUS ACD | ECOBULL M DEX 1/2D | ECOBULL T DEX 1/2D | ECOBULL PLUS DEX 1/2D | ECOBULL M DEX 3/3G | ECOBULL T DEX 3/3G | ECOBULL PLUS DEX 3/3G

- Remove the container as described in Section 4.5.
- From the underside of the filter chamber, unhook the clip and slide out the pin securing the cage to the filter shaker lever.

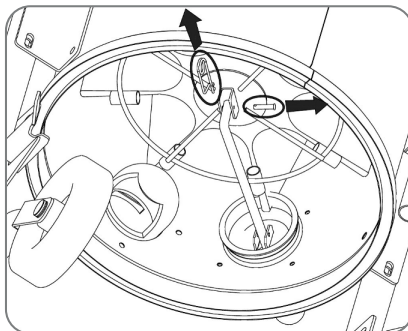

- Unlock the two locking hooks (C) of the head on the filter chamber from both sides.

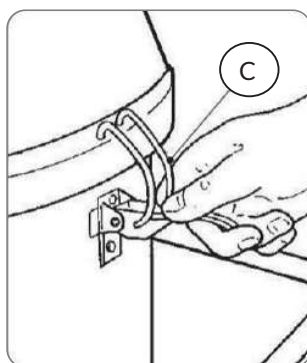

- Remove the head with its base and place it on the workbench.

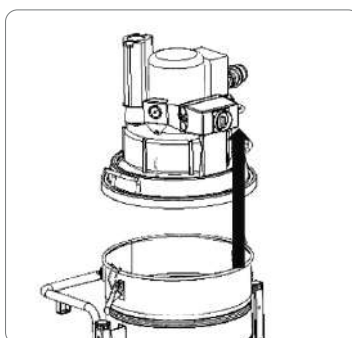



- Remove the filter (E) and place it on the workbench.



- Loosen the fastening clamp (F) and remove the filter from its holder.

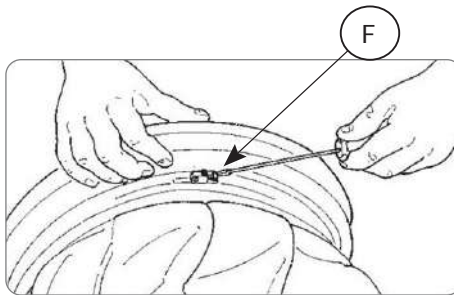

- Using scissors, cut the tapes on the bottom of the filter that secure it to the cage.

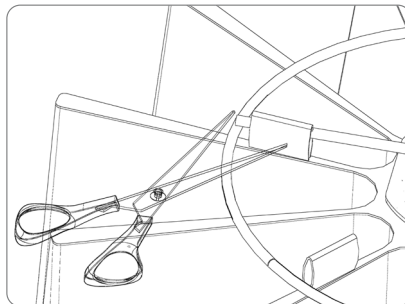



**ECOBULL M H ACD INERT | ECOBULL T H ACD INERT | ECOBULL XM M DEX 1/3D |
ECOBULL XM T DEX 1/3D | ECOBULL XM M DEX 1/2D | ECOBULL XM T DEX 1/2D
| ECOBULL M DEX 1/3D | ECOBULL T DEX 1/3D | ECOBULL PLUS DEX 1/3D | ECO-
BULL M DEX 1/3D INERT | ECOBULL T DEX 1/3D INERT | ECOBULL M DEX 1/2D
INERT | ECOBULL T DEX 1/2D INERT**

- Unlock the two locking hooks (C) of the head on the filter chamber from both sides.

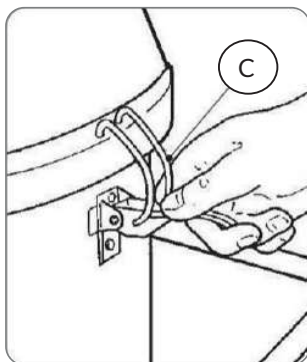

- Remove the head with its base and place it on the workbench.

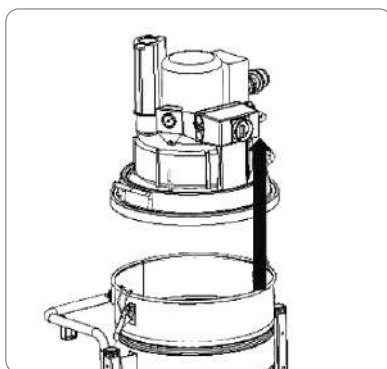

- Using the appropriate equipment, unscrew the screws securing the cartridge and slide it out from inside the filter chamber.

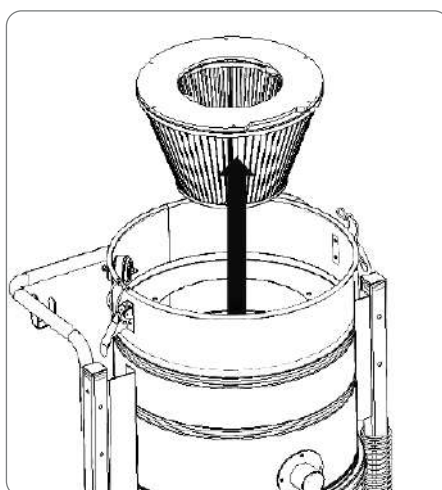



ECOBULL M ATEX SP 3D | ECOBULL T ATEX SP 3D | ECOBULL PLUS ATEX SP 3D

WARNING

Wear appropriate PPE (dust mask, latex gloves, goggles, etc.).

For the **filter replacement primary** Operate as follows:

- Turn off the machine.
- Disconnect the vacuum cleaner from the power supply and compressed air supply.
- Disconnect the SP cleaning system from the power supply by disconnecting the electrical connector (L).

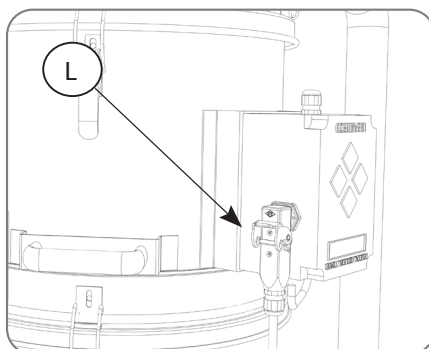

- Unlock the two locking hooks (C) of the head on the filter chamber from both sides.

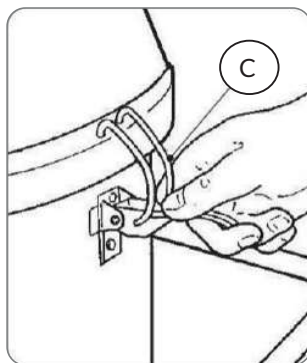

- Remove the head with its base and place it on the workbench.
- Unlock the SP wiping system from the locking hooks (G).

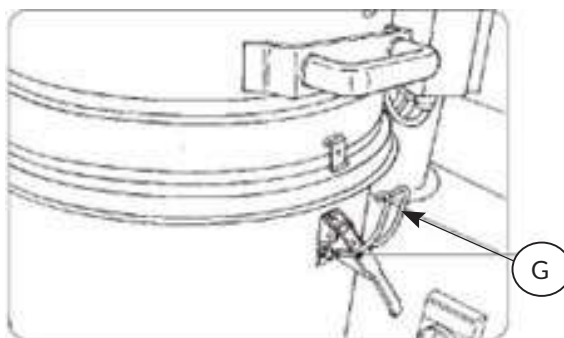



- Using an eyebolt (M) (not included in the scope of supply) with GAS thread with G1 male connection (screw the said eyebolt to the threaded hole on the upper face of the tank (N)) and with the help of suitable equipment (belts and lifting and handling systems), lift the filter cartridge support assembly (H) and place it upside down on a workbench.

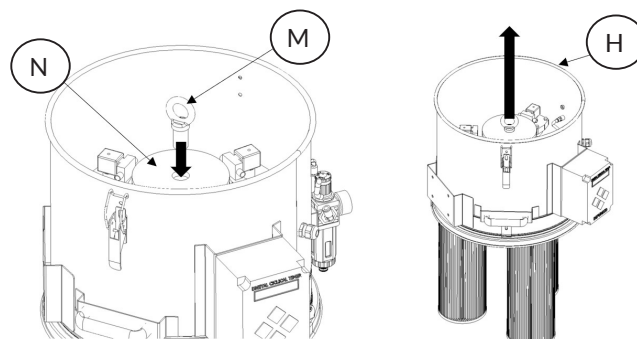

- From the base of the cartridges, remove and unscrew the retaining nuts (I).

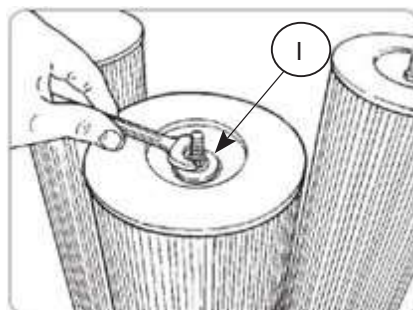

- Slide out and replace the filter cartridges.

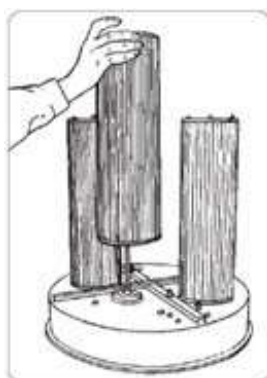

ALL MODELS

WARNING

Remove the filter, place it inside a plastic bag, close it and dispose of it according to current laws for the type of material sucked in.

 **USE ONLY ORIGINAL DEPURECO FILTERS!**

 **TO REASSEMBLE THE FILTER OPERATE THE FOLLOWING OPERATIONS.**



CLEANING OPTION SP - CARTRIDGES IN AIR CONTROCORRENT

ECOBULL M | ECOBULL T | ECOBULL PLUS | ECOBULL M ACD | ECOBULL T ACD | ECOBULL PLUS ACD



WARNING

Wear appropriate PPE (dust mask, latex gloves, goggles, etc.).

For the **filter replacement primary** Operate as follows:

- Turn off the machine.
- Disconnect the vacuum cleaner from the power supply and compressed air supply.
- Disconnect the SP cleaning system from the power supply by disconnecting the electrical connector (L).

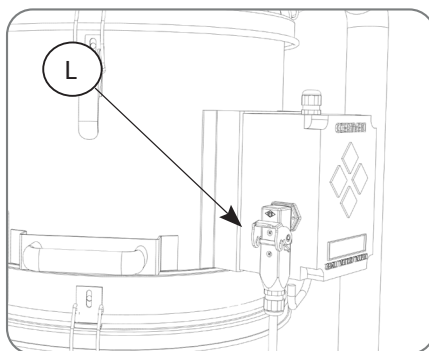

- Unlock the two locking hooks (C) of the head on the filter chamber from both sides.

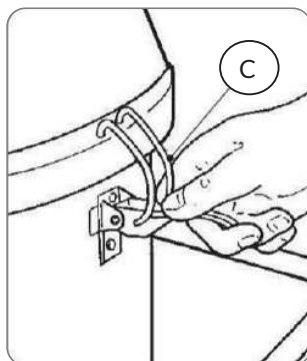

- Remove the head with its base and place it on the workbench.
- Unlock the SP wiping system from the locking hooks (G).

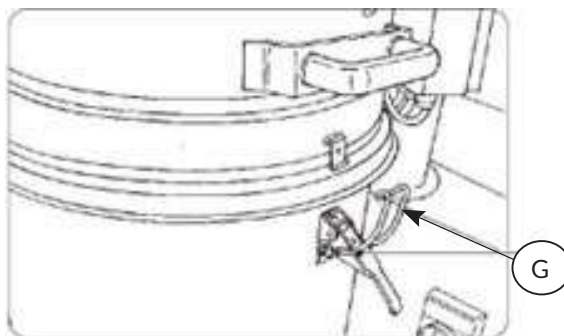



- Using an eyebolt (M) (not included in the scope of supply) with GAS thread with G1 male connection (screw the said eyebolt to the threaded hole on the upper face of the tank (N)) and with the help of suitable equipment (belts and lifting and handling systems), lift the filter cartridge support assembly (H) and place it upside down on a workbench.

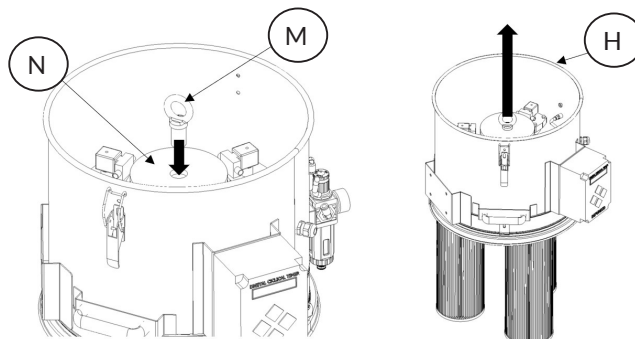

- From the base of the cartridges, remove and unscrew the retaining nuts (I).

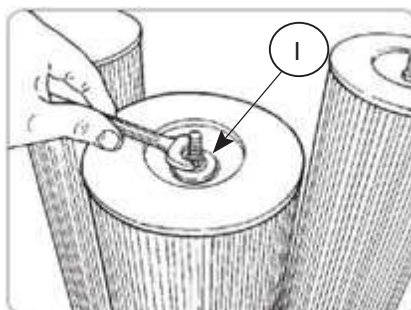

- Slide out and replace the filter cartridges.

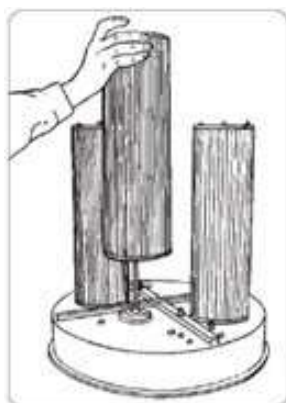

WARNING

Remove the cartridges, place them inside a plastic bag, close it and dispose of it according to current laws for the type of material sucked in.

 USE ONLY ORIGINAL DEPURECO CARTRIDGES!

 TO REASSEMBLE THE CARTRIDGES OPERATE THE ABOVE STEPS BACKWARD.



5.4. HEPA FILTER REPLACEMENT



WARNING

Wear appropriate PPE (dust mask, latex gloves, goggles, etc.).

HEPA FILTER OPTION

ECOBULL M | ECOBULL T | ECOBULL PLUS | ECOBULL M ACD | ECOBULL T ACD | ECOBULL PLUS ACD | ECOBULL XM M DEX 1/3D | ECOBULL XM T DEX 1/3D | ECOBULL XM M DEX 1/2D | ECOBULL XM T DEX 1/2D | ECOBULL M DEX 1/3D | ECOBULL T DEX 1/3D | ECOBULL PLUS DEX 1/3D | ECOBULL M ATEX SP 3D | ECOBULL T ATEX SP 3D | ECOBULL PLUS ATEX SP 3D | ECOBULL M DEX 1/2D | ECOBULL T DEX 1/2D | ECOBULL PLUS DEX 1/2D | ECOBULL M DEX 3/3G | ECOBULL T DEX 3/3G | ECOBULL PLUS DEX 3/3G

For the filter replacement HEPA Operate as follows:

- Turn off the machine.
- Disconnect the vacuum cleaner from the power supply.
- Release from both sides the two closing hooks (C) of the lid on the filter chamber.

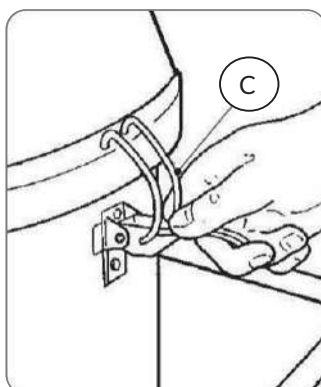

- Remove the head with its base and place it on the workbench.
- Unscrew the fixing nut (O) of the HEPA cartridge.

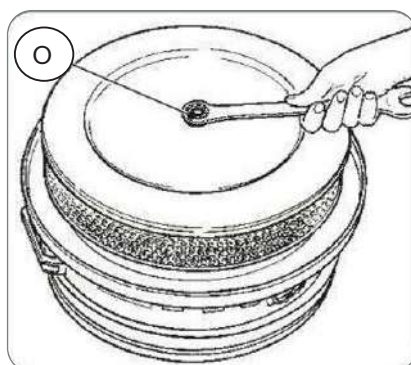



- Remove the HEPA filter from the cover.

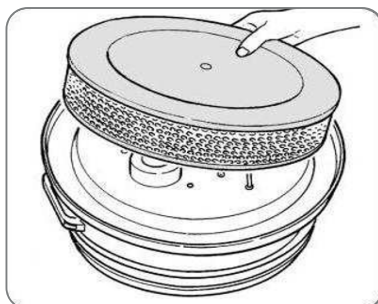

WARNING

Remove the HEPA filter, place it inside a plastic bag, close it, and dispose of it according to current laws for the type of material vacuumed.

 USE ONLY ORIGINAL DEPURECO HEPA FILTERS!

 TO REMOVE THE HEPA FILTER, DO THE FOLLOWING OPERATIONS.



5.5. INERTING KIT FILTER MAINTENANCE AND REPLACEMENT

**ECOBULL M H ACD INERT | ECOBULL T H ACD INERT | ECOBULL M DEX 1/3D INERT |
ECOBULL T DEX 1/3D INERT | ECOBULL M DEX 1/2D INERT | ECOBULL T DEX 1/2D
INERT**

The inerting kit is located inside the inert liquid container (Part 11, Paragraph 1.2). Inside the container there are 3 filtration levels to ensure the highest safety standards, even when vacuuming potentially explosive dust:

1. **Metal grid filter** To trap any sparks.
2. **Nylon filter** which separates metal powders from the inert liquid, enabling their recovery and reuse.
3. **Double sponge filter with air chamber**
Holding back oil mists.

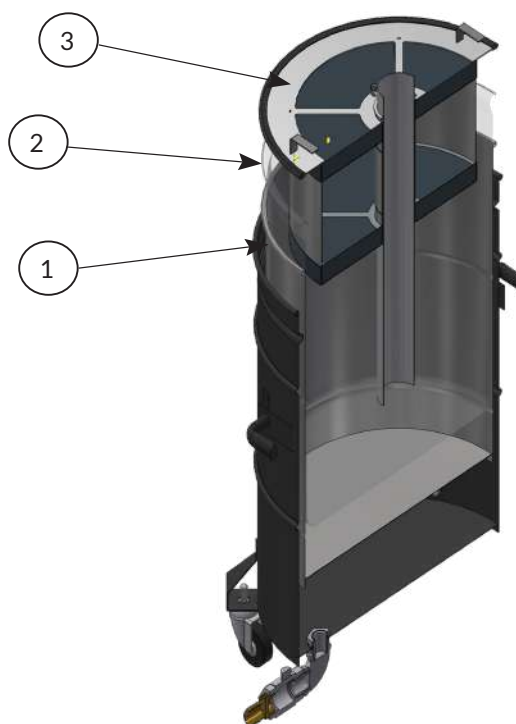

WARNING

Wear appropriate PPE (dust mask, latex gloves, goggles, etc.).

For the **filter maintenance nylon (2)** proceed as follows:

- Turn off the machine.
- Disconnect the vacuum cleaner from the power supply.
- Unhook and remove the container (Section 4.5).
- Remove the double sponge filter kit (3) complete with immersion tube from the container.
- Remove the nylon filter (2) from the basket to clean/wash it or replace it if necessary.



For the **filter kit maintenance double sponge (3)** proceed as follows:

- Turn off the machine.
- Disconnect the vacuum cleaner from the power supply.
- Unhook and remove the container (Section 4.5).
- Remove the double sponge filter kit (3) complete with immersion tube from the container and place it on the workbench.
- Remove the two sponges from the double sponge filter kit (3), one from the top and one from the bottom, pulling them out with a rotating motion and without forcing them.
- Clean/wash the sponges or replace them if necessary.

To maintain or replace the inerting oil, proceed as follows:

- Turn off the machine.
- Disconnect the vacuum cleaner from the power supply.
- Unhook and remove the container (Section 4.5).
- Remove the double sponge filter kit (3) complete with immersion tube, nylon filter (2), and metal mesh filter (1) from the container, then place everything on the workbench.
- Clean/wash the metal mesh filter and clean/wash the sponges and nylon filter, replacing them if necessary.
- Using the ball valve, extract the inerting oil from the container and collect it in a suitable container so that it is not dispersed into the environment.
- Filter or replace the inerting oil after a suitable number of operating hours, depending on the type of dust extracted.



WARNING

Remove the filters, place them inside a plastic bag, close them and dispose of them according to current laws for the type of material sucked in.



USE ONLY ORIGINAL DEPURECO FILTERS!



TO REMOVE THE FILTERS OPERATE THE FOLLOWING OPERATIONS.



5.6. IF SOMETHING DOESN'T WORK

ANOMALY FOUND	POSSIBLE CAUSE	RECOMMENDED REMEDY
The vacuum cleaner does not start.	Lack of power supply.	<ul style="list-style-type: none">• Check for the presence of voltage in the power outlet.• Check the integrity of the plug and power cord.• Contact DEPURECO technical assistance.
Red light on or vacuum gauge indicating irregular vacuum (Section 4.1) (on models where applicable).	Clogged filter.	<ul style="list-style-type: none">• Shake the filter.• If it is not enough, replace it.
Dust leakage from the vacuum cleaner.	<ul style="list-style-type: none">• Filter washed out.• Filter not suitable for the type of material to be vacuumed.	<ul style="list-style-type: none">• Replace the filter.• Mount the filter suitable for the material to be vacuumed.
Excessively noisy engines.	Failed engines.	Contact DEPURECO technical assistance.

5.7. SCRAPPING

WARNING

In case of scrapping, to avoid damage to the environment, all vacuum cleaner components, shall be disposed of responsibly, in appropriate landfills following the relevant national regulations. Vacuum cleaner parts consisting of plastic material, aluminum, steel, may be recycled by delivering them to the appropriate centers.

The crossed-out bin symbol on the label on the equipment indicates that it complies with the regulations on waste electrical and electronic equipment. Abandoning the equipment in the environment or improperly disposing of it is punishable by law.

RAEE REGISTER ENTRY NO. IT18090000010711





MAINTENANCE LOG

MODEL: _____

MATRICOLA: _____

DELIVERY DATE: _____

ENTERPRISE: _____

ADDRESS: _____

N. _____

CITY: _____

ZIP CODE: _____

BUSINESS SECTOR: _____

PHONE: _____

RESPONSIBLE: _____

TIMBERS: _____

Depureco Industrial Vacuums Srl

Company subject to management and coordination COFISE spa

Via Venezia, 32 - 10088 Volpiano (TO)

Tel. +39 011 98.59.117

Fax. +39 011 98.59.326

www.depureco.com

depureco@depureco.com

depureco@documentipec.com

C.F.- and P.I. 02258610357 - **Capital stock:** € 25,000 i.v.

Turin Business Register - **R.E.A.** TO-1149668

Registration **WEEE** No. IT18090000010711



INTERVENTION 1:

DATE:

TECHNICAL ASSISTANCE:

TYPE OF INTERVENTION:

INTERVENTION 2:

DATE:

TECHNICAL ASSISTANCE:

TYPE OF INTERVENTION:

Depureco Industrial Vacuums Srl

Company subject to management and coordination COFISE spa

Via Venezia, 32 - 10088 Volpiano (TO)
Tel. +39 011 98.59.117
Fax. +39 011 98.59.326

www.depureco.com
depureco@depureco.com
depureco@documentipec.com

C.F. and P.I. 02258610357 - **Capital stock:** € 25,000 i.v.
Turin Business Register - **R.E.A.** TO-1149668
Registration **WEEE** No. IT18090000010711



INTERVENTION 3:

DATE:

TECHNICAL ASSISTANCE:

TYPE OF INTERVENTION:

INTERVENTION 4:

DATE:

TECHNICAL ASSISTANCE:

TYPE OF INTERVENTION:

Depureco Industrial Vacuums Srl

Company subject to management and coordination COFISE spa

Via Venezia, 32 - 10088 Volpiano (TO)

Tel. +39 011 98.59.117

Fax. +39 011 98.59.326

www.depureco.com

depureco@depureco.com

depureco@documentipec.com

C.F. and P.I. 02258610357 - **Capital stock:** € 25,000 i.v.

Turin Business Register - **R.E.A.** TO-1149668

Registration **WEEE** No. IT18090000010711

